

**TRAFFIC IMPACT AND ACCESS STUDY**

---

Woodbridge Crossing Residential Development, Stoughton, Massachusetts

***APPENDIX***

---

**TRAFFIC COUNT DATA  
MASSHIGHWAY SEASONAL ADJUSTMENT AND GROWTH DATA  
ACCIDENT CRASH RATE WORKSHEETS  
TRIP-GENERATION CALCULATIONS  
CAPACITY ANALYSIS METHODOLOGY  
CAPACITY AND QUEUE ANALYSIS WORKSHEETS  
SIGNAL WARRANT ANALYSIS WORKSHEET  
CONCEPT PLANS**

---

**TRAFFIC IMPACT AND ACCESS STUDY**

---

Woodbridge Crossing Residential Development, Stoughton, Massachusetts

**TRAFFIC COUNT DATA**

---

Location : Route 27 East of  
 Locallon : West Street  
 City/State: Stoughton, MA  
 Counter : 632

35740001  
 Site Code: 35740001

Time	Sun		Mon		Tue		Wed		Thu		Fri		Sat		Sun		Week Average	
	EB	WB	EB	WB	EB	WB	EB	WB	EB	WB	EB	WB	EB	WB	EB	WB	EB	WB
12:00 AM	*	*	*	*	*	*	57	66	*	*	*	*	*	*	*	*	57	66
02:00	*	*	*	*	*	*	15	34	*	*	*	*	*	*	*	*	15	34
04:00	*	*	*	*	*	*	54	76	*	*	*	*	*	*	*	*	54	76
06:00	*	*	*	*	*	*	491	483	*	*	*	*	*	*	*	*	491	483
08:00	*	*	*	*	*	*	783	719	*	*	*	*	*	*	*	*	783	719
10:00	*	*	*	*	*	*	671	655	*	*	*	*	*	*	*	*	671	655
12:00 PM	*	*	*	*	*	*	780	770	*	*	*	*	*	*	*	*	780	770
02:00	*	*	*	*	*	*	868	862	*	*	*	*	*	*	*	*	868	862
04:00	*	*	*	*	*	*	991	949	*	*	*	*	*	*	*	*	991	949
06:00	*	*	*	*	*	*	868	862	*	*	*	*	*	*	*	*	868	862
08:00	*	*	*	*	*	*	344	414	*	*	*	*	*	*	*	*	344	414
10:00	*	*	*	*	*	*	188	215	*	*	*	*	*	*	*	*	188	215
Lane	0	0	0	0	0	0	12985	12025	0	0	0	0	0	0	0	0	12985	12025
Day	0	0	0	0	0	0	25010	0	0	0	0	0	0	0	0	0	25010	0
AM Peak							08:00	07:00									08:00	07:00
Volume							1156	732									1156	732
PM Peak							17:00	17:00									17:00	17:00
Volume							1007	1039									1007	1039

Comb. Total 0 0 25010 0 0 0 0 25010  
 ADT Not Calculated



Location : Route 27 East of  
Location : West Street  
City/State: Stoughton, MA  
Counter : 632

35740001  
Site Code: 35740001

Start Time	08-Oct-03 Wed	EB		Hour Totals		WB		Hour Totals		Combined Totals	
		Morning	Afternoon	Morning	Afternoon	Morning	Afternoon	Morning	Afternoon	Morning	Afternoon
12:00		19	172			22	217				
12:30		10	188			13	181				
01:00		7	150			11	188				
01:30		4	174			9	163				
02:00		3	188			10	189				
02:30		5	220			7	221				
03:00		5	228			6	196				
03:30		9	227			15	248				
04:00		8	221			13	229				
04:30		14	252			19	239				
05:00		21	235			30	278				
05:30		61	264			49	282				
06:00		56	250			85	253				
06:30		129	191			132	218				
07:00		270	183			172	183				
07:30		245	120			188	136				
08:00		299	108			184	139				
08:30		273	69			186	96				
09:00		235	68			159	82				
09:30		173	69			132	60				
10:00		178	53			168	70				
10:30		185	46			138	55				
11:00		197	28			174	34				
11:30		211	19			170	37				
Total		5330	7655			4326	7699			9656	15354
Percent		41.0%	59.0%			36.0%	64.0%			38.6%	61.4%
Grand Total		5330	7655			4326	7699			9656	15354
Percent		41.0%	59.0%			36.0%	64.0%			38.6%	61.4%

ADT Not Calculated



Location : Mill Street North of  
Location : Route 27  
City/State: Stoughton, MA  
Counter : 232

35740003  
Site Code: 35740003

Start Time	08-Oct-03 Wed	SB		Hour Totals		NB		Hour Totals		Combined Totals	
		Morning	Afternoon	Morning	Afternoon	Morning	Afternoon	Morning	Afternoon	Morning	Afternoon
12:00		0	27			0	18				
12:30		1	23			0	18				
01:00		0	16			0	18				
01:30		0	14			0	20				
02:00		0	16			0	10				
02:30		0	24			0	18				
03:00		0	23			0	16				
03:30		0	25			0	14				
04:00		0	23			0	19				
04:30		0	34			1	12				
05:00		1	32			0	17				
05:30		4	28			4	15				
06:00		2	22			3	16				
06:30		8	14			9	12				
07:00		11	15			13	17				
07:30		13	8			13	20				
08:00		19	5			25	9				
08:30		14	7			22	11				
09:00		8	5			9	7				
09:30		9	2			13	3				
10:00		9	4			6	8				
10:30		10	0			8	1				
11:00		20	1			16	2				
11:30		18	1			8	4				
Total		360	686			314	582			674	1248
Percent		34.4%	65.6%			35.8%	64.2%			35.1%	64.9%
Grand Total		360	686			314	582			674	1248
Percent		34.4%	65.6%			35.8%	64.2%			35.1%	64.9%

ADT Not Calculated





Accurate Counts  
978-664-2565

Location : Mill Street North of  
Location : Route 27  
City/State: Stoughton, MA  
Counter : 232

35740003  
Site Code: 35740003

Start Time	06-Oct-03		Tue		Wed		Thu		Fri		Sat		Sun		Week Average	
	SB	NB	SB	NB	SB	NB	SB	NB	SB	NB	SB	NB	SB	NB	SB	NB
12:00 AM	2	2	2	2	2	2	2	2	2	2	2	2	2	2	2	2
01:00 AM	0	0	0	0	0	0	0	0	0	0	0	0	0	0	0	0
02:00 AM	0	0	0	0	0	0	0	0	0	0	0	0	0	0	0	0
03:00 AM	0	0	0	0	0	0	0	0	0	0	0	0	0	0	0	0
04:00 AM	0	0	0	0	0	0	0	0	0	0	0	0	0	0	0	0
05:00 AM	0	0	0	0	0	0	0	0	0	0	0	0	0	0	0	0
06:00 AM	0	0	0	0	0	0	0	0	0	0	0	0	0	0	0	0
07:00 AM	0	0	0	0	0	0	0	0	0	0	0	0	0	0	0	0
08:00 AM	0	0	0	0	0	0	0	0	0	0	0	0	0	0	0	0
09:00 AM	0	0	0	0	0	0	0	0	0	0	0	0	0	0	0	0
10:00 AM	0	0	0	0	0	0	0	0	0	0	0	0	0	0	0	0
11:00 AM	0	0	0	0	0	0	0	0	0	0	0	0	0	0	0	0
12:00 PM	0	0	0	0	0	0	0	0	0	0	0	0	0	0	0	0
01:00 PM	0	0	0	0	0	0	0	0	0	0	0	0	0	0	0	0
02:00 PM	0	0	0	0	0	0	0	0	0	0	0	0	0	0	0	0
03:00 PM	0	0	0	0	0	0	0	0	0	0	0	0	0	0	0	0
04:00 PM	0	0	0	0	0	0	0	0	0	0	0	0	0	0	0	0
05:00 PM	0	0	0	0	0	0	0	0	0	0	0	0	0	0	0	0
06:00 PM	0	0	0	0	0	0	0	0	0	0	0	0	0	0	0	0
07:00 PM	0	0	0	0	0	0	0	0	0	0	0	0	0	0	0	0
08:00 PM	0	0	0	0	0	0	0	0	0	0	0	0	0	0	0	0
09:00 PM	0	0	0	0	0	0	0	0	0	0	0	0	0	0	0	0
10:00 PM	0	0	0	0	0	0	0	0	0	0	0	0	0	0	0	0
11:00 PM	0	0	0	0	0	0	0	0	0	0	0	0	0	0	0	0
Lane	0	0	0	0	0	0	0	0	0	0	0	0	0	0	0	0
Day	0	0	0	0	0	0	0	0	0	0	0	0	0	0	0	0
AM	0	0	0	0	0	0	0	0	0	0	0	0	0	0	0	0
Peak	0	0	0	0	0	0	0	0	0	0	0	0	0	0	0	0
Volume	0	0	0	0	0	0	0	0	0	0	0	0	0	0	0	0
PM	0	0	0	0	0	0	0	0	0	0	0	0	0	0	0	0
Peak	0	0	0	0	0	0	0	0	0	0	0	0	0	0	0	0
Volume	0	0	0	0	0	0	0	0	0	0	0	0	0	0	0	0
11:00	11:00	08:00	11:00	08:00	11:00	08:00	11:00	08:00	11:00	08:00	11:00	08:00	11:00	08:00	11:00	08:00
82	82	90	82	90	82	90	82	90	82	90	82	90	82	90	82	90
17:00	17:00	12:00	17:00	12:00	17:00	12:00	17:00	12:00	17:00	12:00	17:00	12:00	17:00	12:00	17:00	12:00
109	109	76	109	76	109	76	109	76	109	76	109	76	109	76	109	76
1922	1922	1922	1922	1922	1922	1922	1922	1922	1922	1922	1922	1922	1922	1922	1922	1922

Comb. Total 0 0 1922 0 0 0 0 1922  
ADT Not Calculated







Location : Island Street North of  
Location : Route 27  
City/State: Stoughton, MA  
Counter : 5846

35740002

Site Code: 35740002

Start Time	08-Oct-03 Wed	NB		Hour Totals		SB		Hour Totals		Combined Totals	
		Morning	Afternoon	Morning	Afternoon	Morning	Afternoon	Morning	Afternoon	Morning	Afternoon
12:00		6	23			3	34				
12:30		0	21			1	18				
01:00		1	19			3	28	10	35	20	189
01:30		0	31			0	17				
02:00		0	26			0	34				
02:30		0	41			1	37				
03:00		0	35			2	19				
03:30		0	41			1	38				
04:00		2	45			1	36				
04:30		4	22			0	57				
05:00		2	47			4	53				
05:30		6	44			8	38				
06:00		5	41			11	41	28	165	22	242
06:30		13	19			14	33				
07:00		33	30			27	19	49	112	113	264
07:30		43	28			27	7				
08:00		51	19			35	13	72	58	28	188
08:30		31	17			27	10				
09:00		21	8			22	4	23	12	28	105
09:30		16	18			28	4				
10:00		27	12			28	9	87	18	73	68
10:30		26	4			25	7				
11:00		27	2			26	3	94	28	204	59
11:30		28	3			25	3				
Total		756	1200			632	1101	110	215	225	140
Percent		38.7%	61.3%			36.5%	63.5%			37.6%	62.4%
Grand Total		756	1200			632	1101			1388	2301
Percent		38.7%	61.3%			36.5%	63.5%			37.6%	62.4%

ADT Not Calculated



AUTOMATED COUNTS & TRAFFIC SURVEYS INC.  
 2 BURCHARD AVENUE  
 LITTLE COMPTON, RI 02837  
 (401)635-1650

Site Code : 03100101  
 Start Date: 10/01/03  
 File I.D. : GPIS1001  
 Page : 1

AUTOS

ROUTE 27 Westbound			WEST STREET Northbound			ROUTE 27 Eastbound			Total	
Left	Thru	PEDS	Left	Right	PEDS	Thru	Right	PEDS		
----- * BREAK * -----										
10/01/03	9	143	0	14	62	0	175	7	0	410
	26	167	0	13	56	0	201	9	0	472
	12	157	0	16	70	0	225	4	0	484
	22	145	0	16	82	1	212	9	0	487
al	69	612	0	59	270	1	813	29	0	1853
	25	153	0	17	89	1	230	10	0	525
	26	140	0	21	71	0	191	11	0	460
	15	128	0	18	55	0	171	7	0	394
	20	132	0	9	47	1	170	7	0	386
al	86	553	0	65	262	2	762	35	0	1765
	50	208	0	7	26	2	186	13	0	492
	42	184	0	6	39	2	223	15	0	511
	62	198	0	13	25	0	227	17	0	542
	57	207	0	9	37	0	189	15	0	514
al	211	797	0	35	127	4	825	60	0	2059
	67	223	0	17	31	3	224	14	0	579
	73	213	0	15	43	0	231	17	0	592
	54	235	0	14	27	3	196	22	0	551
	57	164	0	20	53	0	242	11	0	547
al	251	835	0	66	154	6	893	64	0	2269
	617	2797	0	225	813	13	3293	188	0	7946





AUTOMATED COUNTS & TRAFFIC SURVEYS INC.  
 2 BURCHARD AVENUE  
 LITTLE COMPTON, RI 02837  
 (401)635-1650

Site Code : 03100101  
 Start Date: 10/01/03  
 File I.D. : GPIS1001  
 Page : 1

HEAVY VEHICLES

ROUTE 27 Westbound			WEST STREET Northbound			ROUTE 27 Eastbound			Total	
Left	Thru	Other	Left	Right	Other	Thru	Right	Other		
10/01/03										
2	13	0	0	2	0	8	1	0	26	
2	12	0	0	1	0	12	0	0	27	
3	25	0	0	2	0	4	1	0	35	
1	11	0	1	1	0	15	1	0	30	
al	8	61	0	1	6	0	39	3	0	118
3	12	0	0	1	0	10	0	0	26	
3	9	0	0	0	0	7	0	0	19	
2	24	0	0	1	0	9	0	0	36	
1	11	0	1	2	0	9	0	0	24	
al	9	56	0	1	4	0	35	0	0	105
--- * BREAK *										
3	5	0	0	1	0	16	0	0	25	
0	5	0	0	2	0	9	0	0	16	
1	4	0	0	0	0	3	1	0	9	
0	4	0	0	2	0	12	1	0	19	
al	4	18	0	0	5	0	40	2	0	69
1	8	0	1	2	0	9	0	0	21	
0	4	0	0	2	0	6	0	0	12	
1	5	0	0	0	0	5	0	0	11	
1	3	0	1	1	0	8	0	0	14	
al	3	20	0	2	5	0	28	0	0	58
-----										
24	155	0	4	20	0	142	5	0	350	



AUTOMATED COUNTS & TRAFFIC SURVEYS INC.  
 2 BURCHARD AVENUE  
 LITTLE COMPTON, RI 02837  
 (401)635-1650

Site Code : 03100101  
 Start Date: 10/01/03  
 File I.D. : GPIS1001  
 Page : 1

AUTOS, HEAVY VEHICLES

ROUTE 27 Westbound			WEST STREET Northbound			ROUTE 27 Eastbound			Total	
Left	Thru	PEDS	Left	Right	PEDS	Thru	Right	PEDS		
10/01/03										
11	156	0	14	64	0	183	8	0	436	
28	179	0	13	57	0	213	9	0	499	
15	182	0	16	72	0	229	5	0	519	
23	156	0	17	83	1	227	10	0	517	
tal	77	673	0	60	276	1	852	32	0	1971
28	165	0	17	90	1	240	10	0	551	
29	149	0	21	71	0	198	11	0	479	
17	152	0	18	56	0	180	7	0	430	
21	143	0	10	49	1	179	7	0	410	
tal	95	609	0	66	266	2	797	35	0	1870
* BREAK *										
53	213	0	7	27	2	202	13	0	517	
42	189	0	6	41	2	232	15	0	527	
63	202	0	13	25	0	230	18	0	551	
57	211	0	9	39	0	201	16	0	533	
tal	215	815	0	35	132	4	865	62	0	2128
68	231	0	18	33	3	233	14	0	600	
73	217	0	15	45	0	237	17	0	604	
55	240	0	14	27	3	201	22	0	562	
58	167	0	21	54	0	250	11	0	561	
tal	254	855	0	68	159	6	921	64	0	2327
* tal	641	2952	0	229	833	13	3435	193	0	8296

AUTOMATED COUNTS & TRAFFIC SURVEYS INC.  
 2 BURCHARD AVENUE  
 LITTLE COMPTON, RI. 02837  
 (401)635-1650

Site Code : 03100101  
 Start Date: 10/01/03  
 File I.D. : GPIS1001  
 Page : 2

AUTOS, HEAVY VEHICLES

ROUTE 27 Westbound			WEST STREET Northbound			ROUTE 27 Eastbound			Total
Left	Thru	PEDS	Left	Right	PEDS	Thru	Right	PEDS	

10/01/03

0 : 0  
0 : 0

ROUTE 27 229 952    3,181 0 <hr/> 0 <hr/> 293 142    3,435 <hr/> 188 5       193 <hr/> 0 0       0	6,809  3,628  1,896	. AUTOS . HEAVY VEHICLES  Intersection Total 8,283	7,861  1,062	0  3,593    2,952    2,797 .       .       . 155  641    617 .       . 24  4,268    3,435 833  ROUTE 27  813    13 20    0  833    13	WEST STREET 641    225 0       4 193 <hr style="border-top: 1px dashed black;"/> 834    229 0
--	---------------------------------	--	--------------------	---	--

AUTOMATED COUNTS & TRAFFIC SURVEYS INC.  
 2 BURCHARD AVENUE  
 LITTLE COMPTON, RI 02837  
 (401)635-1650

Site Code : 03100101  
 Start Date: 10/01/03  
 File I.D. : GPIS1001  
 Page : 3

AUTOS, HEAVY VEHICLES

ROUTE 27 Westbound			WEST STREET Northbound			ROUTE 27 Eastbound			Total
Left	Thru	PEDS	Left	Right	PEDS	Thru	Right	PEDS	
10/01/03									
Hour Analysis By Individual Approach for the Period: 07:00 to 12:30 on 10/01/03									
start 07:15			07:30			07:15			
ve	94	682	0	71	316	2	909	34	0
nt	12	88	0	18	81	1	96	4	0
ital	776			389			943		
start 07:15			08:00			08:00			
ve	28	179	0	17	90	1	240	10	0
ital	207			108			250		
	.94			.90			.94		

AUTOMATED COUNTS & TRAFFIC SURVEYS INC.  
 2 BURCHARD AVENUE  
 LITTLE COMPTON, RI 02837  
 (401)635-1650

Site Code : 03100101  
 Start Date: 10/01/03  
 File I.D. : GPIS1001  
 Page : 4

AUTOS, HEAVY VEHICLES

ROUTE 27 Westbound			WEST STREET Northbound			ROUTE 27 Eastbound			Total
Left	Thru	PEDS	Left	Right	PEDS	Thru	Right	PEDS	
10/01/03									
Four Analysis By Entire Intersection for the Period: 07:00 to 12:30 on 10/01/03									
start 07:15									
94	682	0	63	302	2	909	34	0	
12	88	0	17	82	1	96	4	0	
Total 776			367			943			
start 07:15									
28	179	0	17	90	1	240	10	0	
Total 207			108			250			
.94			.85			.94			

0  
0

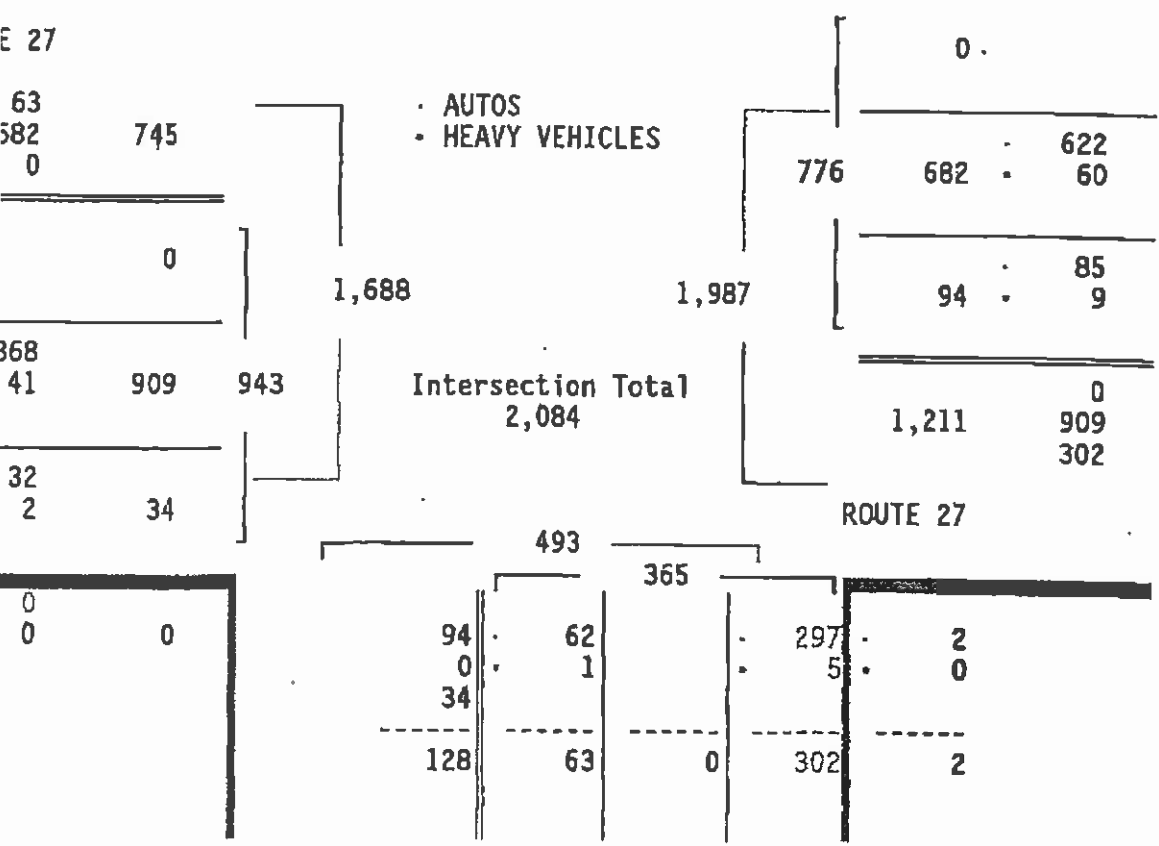

AUTOMATED COUNTS & TRAFFIC SURVEYS INC.  
 2 BURCHARD AVENUE  
 LITTLE COMPTON, RI 02837  
 (401)635-1650

Site Code : 03100101  
 Start Date: 10/01/03  
 File I.D. : GPIS1001  
 Page : 5

AUTOS, HEAVY VEHICLES

ROUTE 27 Westbound			WEST STREET Northbound			ROUTE 27 Eastbound			Total
Left	Thru	PEDS	Left	Right	PEDS	Thru	Right	PEDS	
10/01/03									
Hour Analysis By Individual Approach for the Period: 12:30 to 18:00 on 10/01/03									
start 16:45			17:00			17:00			
e	253	899	0	68	159	6	921	64	0
nt	22	78	0	29	68	3	94	6	0
tal	1152			233			985		
st 17:00			17:45			17:45			
e	68	231	0	21	54	0	250	11	0
tal	299			75			261		
	.96			.78			.94		

AUTOMATED COUNTS & TRAFFIC SURVEYS INC.  
 2 BURCHARD AVENUE  
 LITTLE COMPTON, RI 02837  
 (401)635-1650

Site Code : 03100101  
 Start Date: 10/01/03  
 File I.D. : GPIS1001  
 Page : 6

er : CLEAR/COOL  
 er : D-2618  
 ed by: RT  
 nts: STOUGHTON

AUTOS, HEAVY VEHICLES

ROUTE 27 Westbound			WEST STREET Northbound			ROUTE 27 Eastbound			Total
Left	Thru	PEDS	Left	Right	PEDS	Thru	Right	PEDS	
10/01/03									
Hour Analysis By Entire Intersection for the Period: 12:30 to 18:00 on 10/01/03									
start 17:00			17:00			17:00			
254	855	0	68	159	6	921	64	0	
234	774	0	294	684	34	944	64	0	
Total 1109			233			985			
start 17:00			17:45			17:45			
68	231	0	21	54	0	250	11	0	
Total 299			75			261			
.93			.78			.94			

0  
0

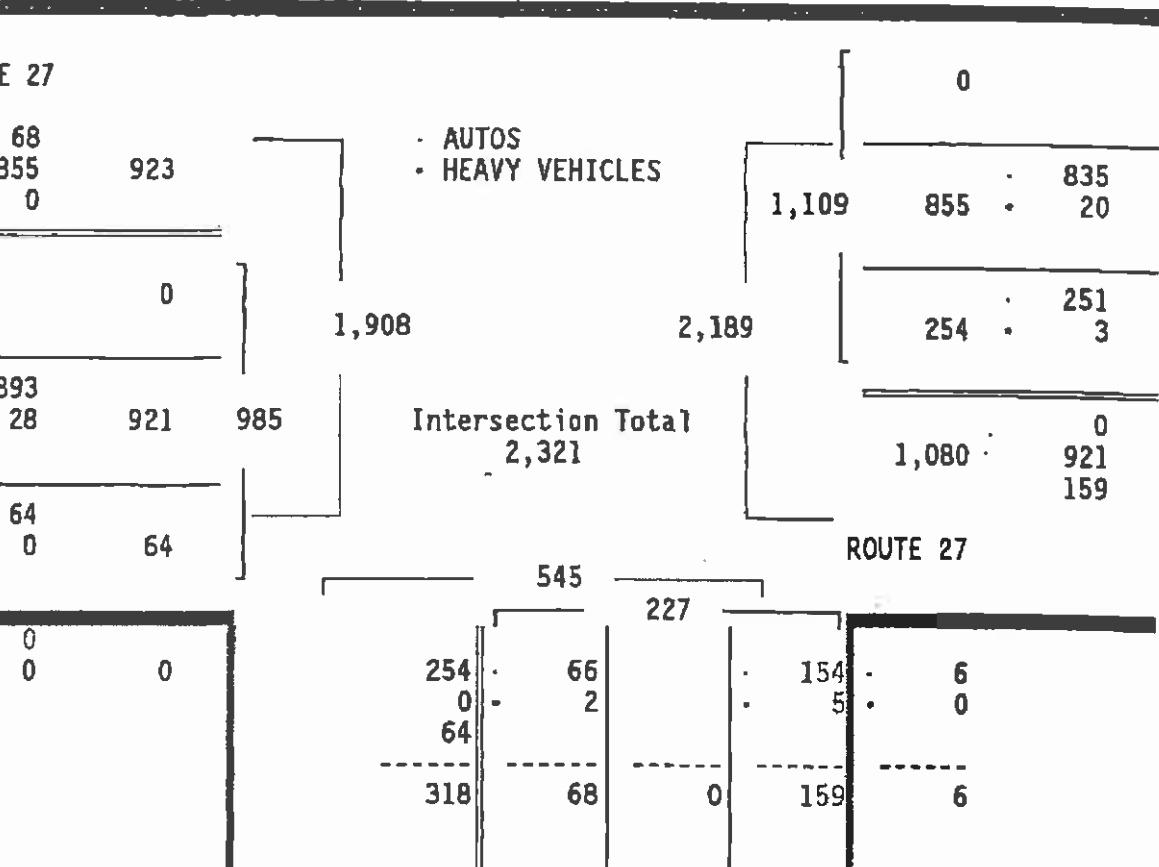



AUTOMATED COUNTS & TRAFFIC SURVEYS INC.  
 2 BURCHARD AVENUE  
 LITTLE COMPTON, RI 02837  
 (401)635-1650

Site Code : 03093002  
 Start Date: 09/30/03  
 File I.D. : GPIS0902  
 Page : 1

AUTOS

ISLAND ST Southbound			ROUTE 27 Westbound			ROUTE 27 Eastbound			Total
Left	Right	PEDS	Thru	Right	PEDS	Left	Thru	PEDS	
09/30/03									
21	4	0	148	20	0	17	196	0	406
22	1	0	184	27	0	14	236	0	484
17	5	0	159	18	0	28	257	0	484
16	12	0	158	20	0	41	258	0	505
<b>tal</b>	<b>76</b>	<b>22</b>	<b>649</b>	<b>85</b>	<b>0</b>	<b>100</b>	<b>947</b>	<b>0</b>	<b>1879</b>
23	12	0	171	17	0	35	280	0	538
21	12	0	155	15	0	25	254	0	482
17	7	0	151	20	0	19	267	0	481
20	5	0	130	8	0	11	268	0	442
<b>tal</b>	<b>81</b>	<b>36</b>	<b>607</b>	<b>60</b>	<b>0</b>	<b>90</b>	<b>1069</b>	<b>0</b>	<b>1943</b>
* BREAK *									
24	15	0	223	30	0	4	216	0	512
26	15	0	217	19	0	9	219	0	505
32	25	0	246	27	0	4	227	0	561
22	27	0	249	27	0	6	223	0	554
<b>tal</b>	<b>104</b>	<b>82</b>	<b>935</b>	<b>103</b>	<b>0</b>	<b>23</b>	<b>885</b>	<b>0</b>	<b>2132</b>
20	20	0	256	34	0	6	241	0	577
18	23	0	249	22	0	6	243	0	561
17	18	0	247	23	0	9	232	0	546
26	9	0	222	27	0	7	231	0	522
<b>tal</b>	<b>81</b>	<b>70</b>	<b>974</b>	<b>106</b>	<b>0</b>	<b>28</b>	<b>947</b>	<b>0</b>	<b>2206</b>
<b>tal</b>	<b>342</b>	<b>210</b>	<b>3165</b>	<b>354</b>	<b>0</b>	<b>241</b>	<b>3848</b>	<b>0</b>	<b>8160</b>



AUTOMATED COUNTS & TRAFFIC SURVEYS INC.  
 2 BURCHARD AVENUE  
 LITTLE COMPTON, RI 02837  
 (401)635-1650

Site Code : 03093002  
 Start Date: 09/30/03  
 File I.D. : GPIS0902  
 Page : 1

HEAVY VEHICLES

ISLAND ST Southbound			ROUTE 27 Westbound			ROUTE 27 Eastbound			Total	
Left	Right	Other	Thru	Right	Other	Left	Thru	Other		
09/30/03										
3	0	0	18	0	0	0	10	0	31	
1	1	0	16	0	0	2	10	0	30	
1	0	0	13	1	0	0	12	0	27	
0	0	0	20	1	0	2	18	0	41	
<b>tal</b>	<b>5</b>	<b>1</b>	<b>0</b>	<b>67</b>	<b>2</b>	<b>0</b>	<b>4</b>	<b>50</b>	<b>0</b>	<b>129</b>
0	2	0	14	1	0	0	13	0	30	
0	2	0	17	3	0	0	19	0	41	
0	0	0	15	3	0	0	9	0	27	
0	0	0	17	4	0	1	10	0	32	
<b>tal</b>	<b>0</b>	<b>4</b>	<b>0</b>	<b>63</b>	<b>11</b>	<b>0</b>	<b>1</b>	<b>51</b>	<b>0</b>	<b>130</b>
* BREAK *										
2	1	0	11	1	0	0	12	0	27	
2	0	0	8	1	0	0	11	0	22	
2	0	0	4	1	0	2	17	0	26	
0	0	0	3	1	0	1	8	0	13	
<b>tal</b>	<b>6</b>	<b>1</b>	<b>0</b>	<b>26</b>	<b>4</b>	<b>0</b>	<b>3</b>	<b>48</b>	<b>0</b>	<b>88</b>
0	1	0	2	0	0	0	6	0	9	
0	0	0	6	0	0	1	9	0	16	
2	0	0	4	1	0	0	4	0	11	
1	0	0	4	0	0	0	6	0	11	
<b>tal</b>	<b>3</b>	<b>1</b>	<b>0</b>	<b>16</b>	<b>1</b>	<b>0</b>	<b>1</b>	<b>25</b>	<b>0</b>	<b>47</b>
* 14 7 0   172 18 0   9 174 0   394										



AUTOMATED COUNTS & TRAFFIC SURVEYS INC.  
 2 BURCHARD AVENUE  
 LITTLE COMPTON, RI 02837  
 (401)635-1650

Site Code : 03093002  
 Start Date: 09/30/03  
 File I.D. : GPIS0902  
 Page : 1

AUTOS, HEAVY VEHICLES

ISLAND ST Southbound			ROUTE 27 Westbound			ROUTE 27 Eastbound			Total	
Left	Right	PEDS	Thru	Right	PEDS	Left	Thru	PEDS		
09/30/03										
24	4	0	166	20	0	17	206	0	437	
23	2	0	200	27	0	16	246	0	514	
18	5	0	172	19	0	28	269	0	511	
16	12	0	178	21	0	43	276	0	546	
<b>tal</b>	<b>81</b>	<b>23</b>	<b>0</b>	<b>716</b>	<b>87</b>	<b>0</b>	<b>104</b>	<b>997</b>	<b>0</b>	<b>2008</b>
23	14	0	185	18	0	35	293	0	568	
21	14	0	172	18	0	25	273	0	523	
17	7	0	166	23	0	19	276	0	508	
20	5	0	147	12	0	12	278	0	474	
<b>tal</b>	<b>81</b>	<b>40</b>	<b>0</b>	<b>670</b>	<b>71</b>	<b>0</b>	<b>91</b>	<b>1120</b>	<b>0</b>	<b>2073</b>
* BREAK *										
26	16	0	234	31	0	4	228	0	539	
28	15	0	225	20	0	9	230	0	527	
34	25	0	250	28	0	6	244	0	587	
22	27	0	252	28	0	7	231	0	567	
<b>tal</b>	<b>110</b>	<b>83</b>	<b>0</b>	<b>961</b>	<b>107</b>	<b>0</b>	<b>26</b>	<b>933</b>	<b>0</b>	<b>2220</b>
20	21	0	258	34	0	6	247	0	586	
18	23	0	255	22	0	7	252	0	577	
19	18	0	251	24	0	9	236	0	557	
27	9	0	226	27	0	7	237	0	533	
<b>tal</b>	<b>84</b>	<b>71</b>	<b>0</b>	<b>990</b>	<b>107</b>	<b>0</b>	<b>29</b>	<b>972</b>	<b>0</b>	<b>2253</b>
* 356 217 0   3337 372 0   250 4022 0   8554										

AUTOMATED COUNTS & TRAFFIC SURVEYS INC.  
 2 BURCHARD AVENUE  
 LITTLE COMPTON, RI 02837  
 (401)635-1650

Site Code : 03093002  
 Start Date: 09/30/03  
 File I.D. : GPIS0902  
 Page : 2

AUTOS, HEAVY VEHICLES

ISLAND ST Southbound			ROUTE 27 Westbound			ROUTE 27 Eastbound			Total
Left	Right	PEDS	Thru	Right	PEDS	Left	Thru	PEDS	

ISLAND ST			ISLAND ST			ISLAND ST		
0	0	210	0	0	342	0	0	250
0	0	7	0	0	14	0	0	0
-----			-----			-----		
0	0	217	0	0	356	0	0	372
-----			-----			-----		
573			1,195			622		

ISLAND ST			ISLAND ST			ISLAND ST		
0	0	210	0	0	342	0	0	250
0	0	7	0	0	14	0	0	0
-----			-----			-----		
0	0	217	0	0	356	0	0	372
-----			-----			-----		
573			1,195			622		

ISLAND ST			ISLAND ST			ISLAND ST		
0	0	210	0	0	342	0	0	250
0	0	7	0	0	14	0	0	0
-----			-----			-----		
0	0	217	0	0	356	0	0	372
-----			-----			-----		
573			1,195			622		

ISLAND ST			ISLAND ST			ISLAND ST		
0	0	210	0	0	342	0	0	250
0	0	7	0	0	14	0	0	0
-----			-----			-----		
0	0	217	0	0	356	0	0	372
-----			-----			-----		
573			1,195			622		

ISLAND ST			ISLAND ST			ISLAND ST		
0	0	210	0	0	342	0	0	250
0	0	7	0	0	14	0	0	0
-----			-----			-----		
0	0	217	0	0	356	0	0	372
-----			-----			-----		
573			1,195			622		

ISLAND ST			ISLAND ST			ISLAND ST		
0	0	210	0	0	342	0	0	250
0	0	7	0	0	14	0	0	0
-----			-----			-----		
0	0	217	0	0	356	0	0	372
-----			-----			-----		
573			1,195			622		

ISLAND ST			ISLAND ST			ISLAND ST		
0	0	210	0	0	342	0	0	250
0	0	7	0	0	14	0	0	0
-----			-----			-----		
0	0	217	0	0	356	0	0	372
-----			-----			-----		
573			1,195			622		

ISLAND ST			ISLAND ST			ISLAND ST		
0	0	210	0	0	342	0	0	250
0	0	7	0	0	14	0	0	0
-----			-----			-----		
0	0	217	0	0	356	0	0	372
-----			-----			-----		
573			1,195			622		

ISLAND ST			ISLAND ST			ISLAND ST		
0	0	210	0	0	342	0	0	250
0	0	7	0	0	14	0	0	0
-----			-----			-----		
0	0	217	0	0	356	0	0	372
-----			-----			-----		
573			1,195			622		

0  
0

ROUTE 27

AUTOMATED COUNTS & TRAFFIC SURVEYS INC.  
 2 BURCHARD AVENUE  
 LITTLE COMPTON, RI 02837  
 (401)635-1650

Site Code : 03093002  
 Start Date: 09/30/03  
 File I.D. : GPIS0902  
 Page : 3

AUTOS, HEAVY VEHICLES

ISLAND ST Southbound			ROUTE 27 Westbound			ROUTE 27 Eastbound			Total
Left	Right	PEDS	Thru	Right	PEDS	Left	Thru	PEDS	
09/30/03									
Hour Analysis By Individual Approach for the Period: 07:00 to 12:30 on 09/30/03									
start 07:45			07:15			07:30			
e	77	47	0	735	85	0	131	1111	0
nt	62	38	0	90	10	0	11	89	0
tal	124			820			1242		
start 08:00			07:15			08:00			
e	23	14	0	200	27	0	35	293	0
tal	37			227			328		
	.84			.90			.95		

AUTOMATED COUNTS & TRAFFIC SURVEYS INC.  
 2 BURCHARD AVENUE  
 LITTLE COMPTON, RI 02837  
 (401)635-1650

Site Code : 03093002  
 Start Date: 09/30/03  
 File I.D. : GPIS0902  
 Page : 4

AUTOS, HEAVY VEHICLES

ISLAND ST Southbound			ROUTE 27 Westbound			ROUTE 27 Eastbound			Total
Left	Right	PEDS	Thru	Right	PEDS	Left	Thru	PEDS	

09/30/03

Hour Analysis By Entire Intersection for the Period: 07:00 to 12:30 on 09/30/03

start 07:30			07:30			07:30			Total
Left	Right	PEDS	Thru	Right	PEDS	Left	Thru	PEDS	
78	45	0	707	76	0	131	1111	0	
63%	37%	0%	90%	10%	0%	11%	89%	0%	
Total 123			783			1242			
start 08:00			08:00			08:00			Total
Left	Right	PEDS	Thru	Right	PEDS	Left	Thru	PEDS	
23	14	0	185	18	0	35	293	0	
Total 37			203			328			
.83			.96			.95			

ISLAND ST				
0	41	77	131	
0	4	1	0	
			76	
0	45	0	78	207
123			330	

ISLAND ST			ROUTE 27		
0	752	1,994	783	70	6
707			707	643	
45				64	
1,242			1,972		
129	131		0		
2					
1,449			1,972		
049	1,111	1,242	Intersection Total		
62			2,148		
0			1,189		
0			1,111		
0			0		

0  
0



AUTOMATED COUNTS & TRAFFIC SURVEYS INC.  
 2 BURCHARD AVENUE  
 LITTLE COMPTON, RI 02837  
 (401)635-1650

Site Code : 03093002  
 Start Date: 09/30/03  
 File I.D. : GPIS0902  
 Page : 5

AUTOS, HEAVY VEHICLES

ISLAND ST Southbound			ROUTE 27 Westbound			ROUTE 27 Eastbound			Total
Left	Right	PEDS	Thru	Right	PEDS	Left	Thru	PEDS	
09/30/03									
Hour Analysis By Individual Approach for the Period: 12:30 to 18:00 on 09/30/03									
start 16:00			16:30			17:00			
ave	110	83	0	1015	112	0	29	972	0
nt	57%	43%	0%	90%	10%	0%	3%	97%	0%
tal	193			1127			1001		
start 16:30			17:00			17:15			
ave	34	25	0	258	34	0	7	252	0
tal	59			292			259		
	.82			.96			.97		

AUTOMATED COUNTS & TRAFFIC SURVEYS INC.  
 2 BURCHARD AVENUE  
 LITTLE COMPTON, RI 02837  
 (401)635-1650

Site Code : 03093002  
 Start Date: 09/30/03  
 File I.D. : GPIS0902  
 Page : 6

AUTOS, HEAVY VEHICLES

ISLAND ST Southbound			ROUTE 27 Westbound			ROUTE 27 Eastbound			Total
Left	Right	PEDS	Thru	Right	PEDS	Left	Thru	PEDS	

09/30/03  
 Hour Analysis By Entire Intersection for the Period: 12:30 to 18:00 on 09/30/03

start	16:30	16:30	16:30	16:30	16:30	16:30	16:30	16:30	16:30
Left	94	96	0	1015	112	0	26	974	0
Right	49	51	0	90	10	0	3	97	0
Total	190			1127			1000		
start	17:00	17:00	17:00	17:00	17:00	17:00	17:00	17:00	17:00
Left	34	25	0	258	34	0	7	252	0
Total	59			292			259		
	.81			.96			.97		

ISLAND ST			ISLAND ST			ISLAND ST		
Left	0	95	Left	92	26	Left	0	0
Right	0	1	Right	2	0	Right	0	0
Total	0	96	Total	94	112	Total	0	0
190			328					

E 27			ROUTE 27		
Left	0	1,111	Left	1,127	1,015
Right	22	26	Right	1,015	15
Total	934	1,137	Total	2,195	1,030
Left	40	974	Left	1,068	94
Right	0	1,000	Right	974	0
Total	40	1,974	Total	2,042	94
Intersection Total 2,317					

0  
 0

AUTOMATED COUNTS & TRAFFIC SURVEYS INC.  
 2 BURCHARD AVENUE  
 LITTLE COMPTON, RI 02837  
 (401)635-1650

Site Code : 03093001  
 Start Date: 09/30/03  
 File I.D. : GPIS0901  
 Page : 1

AUTOS

MILL ST Southbound				ROUTE 27 Westbound			ROUTE 27 Eastbound			Total
Left	Right	PEDS	Thru	Right	PEDS	Left	Thru	PEDS		
09/30/03										
0	4	12	0	148	2	0	10	164	0	340
5	2	10	0	175	0	0	7	185	0	379
0	1	9	0	158	1	0	15	215	0	399
5	1	8	0	145	2	0	18	238	0	412
total	8	39	0	626	5	0	50	802	0	1530
0	3	16	0	181	4	0	18	233	0	455
5	4	11	0	163	1	0	16	207	0	402
0	5	10	0	153	2	0	18	226	0	414
5	6	11	0	130	1	0	7	211	0	366
total	18	48	0	627	8	0	59	877	0	1637
* BREAK *										
0	4	14	0	204	3	0	10	190	0	425
5	8	11	0	194	3	0	11	202	0	429
0	0	13	0	209	2	1	9	222	0	456
5	1	18	0	220	4	0	8	214	0	465
total	13	56	0	827	12	1	38	828	0	1775
0	5	29	0	216	0	0	14	211	0	475
5	1	15	1	207	3	0	15	219	0	461
0	4	18	0	205	2	0	12	215	0	456
5	4	15	0	191	6	0	8	199	0	423
total	14	77	1	819	11	0	49	844	0	1815
total	53	220	1	2899	36	1	196	3351	0	6757



AUTOMATED COUNTS & TRAFFIC SURVEYS INC.  
 2 BURCHARD AVENUE  
 LITTLE COMPTON, RI 02837  
 (401)635-1650

Site Code : 03093001  
 Start Date: 09/30/03  
 File I.D. : GPIS0901  
 Page : 1

HEAVY VEHICLES

MILL ST Southbound			ROUTE 27 Westbound			ROUTE 27 Eastbound			Total	
Left	Right	Other	Thru	Right	Other	Left	Thru	Other		
09/30/03										
0	0	0	14	0	0	0	8	0	22	
0	1	0	17	2	0	0	10	0	30	
0	0	0	12	0	0	0	12	0	24	
0	1	0	18	0	0	0	18	0	37	
al	0	2	0	61	2	0	0	48	0	113
0	0	0	9	0	0	1	13	0	23	
0	0	0	21	0	0	1	13	0	35	
0	1	0	12	0	0	0	10	0	23	
0	0	0	16	0	0	1	10	0	27	
al	0	1	0	58	0	0	3	46	0	108
* BREAK *										
0	0	0	11	0	0	1	9	0	21	
0	0	0	6	0	0	1	13	0	20	
0	0	0	6	0	0	0	17	0	23	
0	0	0	3	0	0	0	6	0	9	
al	0	0	0	26	0	0	2	45	0	73
0	0	0	4	0	0	0	4	0	8	
0	0	0	6	0	0	2	12	0	20	
0	1	0	3	0	0	0	5	0	9	
0	0	0	5	0	0	0	6	0	11	
al	0	1	0	18	0	0	2	27	0	48
* 0	4	0	163	2	0	7	166	0	342	



AUTOMATED COUNTS & TRAFFIC SURVEYS INC.  
 2 BURCHARD AVENUE  
 LITTLE COMPTON, RI 02837  
 (401)635-1650

Site Code : 03093001  
 Start Date: 09/30/03  
 File I.D. : GPIS0901  
 Page : 1

AUTOS, HEAVY VEHICLES

MILL ST Southbound			ROUTE 27 Westbound			ROUTE 27 Eastbound			Total	
Left	Right	PEDS	Thru	Right	PEDS	Left	Thru	PEDS		
09/30/03										
4	12	0	162	2	0	10	172	0	362	
2	11	0	192	2	0	7	195	0	409	
1	9	0	170	1	0	15	227	0	423	
1	9	0	163	2	0	18	256	0	449	
<b>al</b>	<b>8</b>	<b>41</b>	<b>0</b>	<b>687</b>	<b>7</b>	<b>0</b>	<b>50</b>	<b>850</b>	<b>0</b>	<b>1643</b>
3	16	0	190	4	0	19	246	0	478	
4	11	0	184	1	0	17	220	0	437	
5	11	0	165	2	0	18	236	0	437	
6	11	0	146	1	0	8	221	0	393	
<b>al</b>	<b>18</b>	<b>49</b>	<b>0</b>	<b>685</b>	<b>8</b>	<b>0</b>	<b>62</b>	<b>923</b>	<b>0</b>	<b>1745</b>
* BREAK *										
4	14	0	215	3	0	11	199	0	446	
8	11	0	200	3	0	12	215	0	449	
0	13	0	215	2	1	9	239	0	479	
1	18	0	223	4	0	8	220	0	474	
<b>al</b>	<b>13</b>	<b>56</b>	<b>0</b>	<b>853</b>	<b>12</b>	<b>1</b>	<b>40</b>	<b>873</b>	<b>0</b>	<b>1848</b>
5	29	0	220	0	0	14	215	0	483	
1	15	1	213	3	0	17	231	0	481	
4	19	0	208	2	0	12	220	0	465	
4	15	0	196	6	0	8	205	0	434	
<b>al</b>	<b>14</b>	<b>78</b>	<b>1</b>	<b>837</b>	<b>11</b>	<b>0</b>	<b>51</b>	<b>871</b>	<b>0</b>	<b>1863</b>
<b>*</b>	<b>53</b>	<b>224</b>	<b>1</b>	<b>3062</b>	<b>38</b>	<b>1</b>	<b>203</b>	<b>3517</b>	<b>0</b>	<b>7099</b>

AUTOMATED COUNTS & TRAFFIC SURVEYS INC.  
 2 BURCHARD AVENUE  
 LITTLE COMPTON, RI 02837  
 (401)635-1650

Site Code : 03093001  
 Start Date: 09/30/03  
 File I.D. : GPIS0901  
 Page : 2

AUTOS, HEAVY VEHICLES

MILL ST Southbound			ROUTE 27 Westbound			ROUTE 27 Eastbound			Total
Left	Right	PEDS	Thru	Right	PEDS	Left	Thru	PEDS	

09/30/03									
1	0	0	220	4	0	53	0	0	38
1			224		0	53		241	
			277			518			

E 27							
0	062	3,286	224	7,006	3,100	3,062	2,899
196	7	203	3,720	6,670	0	0	163
351	166	3,517	7,097	Intersection Total	3,570	3,517	53
	0					0	0
				ROUTE 27			

0  
 0      0



AUTOMATED COUNTS & TRAFFIC SURVEYS INC.  
 2 BURCHARD AVENUE  
 LITTLE COMPTON, RI 02837  
 (401)635-1650

Site Code : 03093001  
 Start Date: 09/30/03  
 File I.D. : GPIS0901  
 Page : 3

er : CLEAR/COOL  
 er : D-2613  
 ed by: JTS  
 nts: STOUGHTON

AUTOS, HEAVY VEHICLES

MILL ST Southbound				ROUTE 27 Westbound			ROUTE 27 Eastbound			Total
Left	Right	PEDS	Thru	Right	PEDS	Left	Thru	PEDS		
09/30/03										
Hour Analysis By Individual Approach for the Period: 07:00 to 12:30 on 09/30/03										
start 08:00				07:15			07:45			
e	18	49	0	715	9	0	72	958	0	
nt	27%	73%	0%	99%	1%	0%	7%	93%	0%	
tal	67			724			1030			
st 08:00				07:15			07:45			
e	3	16	0	192	2	0	18	256	0	
tal	19			194			274			
	.88			.93			.94			

AUTOMATED COUNTS & TRAFFIC SURVEYS INC.  
 2 BURCHARD AVENUE  
 LITTLE COMPTON, RI 02837  
 (401)635-1650

Site Code : 03093001  
 Start Date: 09/30/03  
 File I.D. : GPIS0901  
 Page : 4

er : CLEAR/COOL  
 er : D-2613  
 ed by: JTS  
 nts: STOUGHTON

AUTOS, HEAVY VEHICLES

MILL ST Southbound				ROUTE 27 Westbound			ROUTE 27 Eastbound			Total
Left	Right	PEDS		Thru	Right	PEDS	Left	Thru	PEDS	

09/30/03

Hour Analysis By Entire Intersection for the Period: 07:00 to 12:30 on 09/30/03

start 07:45				07:45			07:45		
e	13	47	0	702	9	0	72	958	0
nt	22	78	0	99	1	0	7	93	0
tal	60			711			1030		
start 08:00				08:00			07:45		
e	3	16	0	190	4	0	18	256	0
tal	19			194			274		
	.79			.92			.94		

MILL ST				MILL ST				MILL ST			
.	0	.	45	.	13	.	72				
.	0	.	2	.	0	.	0				
							9				
	0		47	0	13		81		0		0
			60				141				

E 27				MILL ST				ROUTE 27			
0				.	13	.	72				
702	749			.	0	.	0				
47							9				
			70				81				
2	72						9				
			904				1,779				
54	958	1,030					1,682		9		9
			0				1,801				
			0				1,801				
			0				1,801				

Intersection Total  
1,801

ROUTE 27

0  
0

AUTOMATED COUNTS & TRAFFIC SURVEYS INC.  
 2 BURCHARD AVENUE  
 LITTLE COMPTON, RI 02837  
 (401)635-1650

Site Code : 03093001  
 Start Date: 09/30/03  
 File I.D. : GPIS0901  
 Page : 5

AUTOS, HEAVY VEHICLES

HILL ST Southbound			ROUTE 27 Westbound			ROUTE 27 Eastbound			Total
Left	Right	PEDS	Thru	Right	PEDS	Left	Thru	PEDS	
09/30/03									
Hour Analysis By Individual Approach for the Period: 12:30 to 18:00 on 09/30/03									
start 17:00			16:30			16:30			
ie	14	78	1	871	9	1	48	905	0
nt	15%	84%	1%	99%	1%	0%	5%	95%	0%
ital	93			881			953		
:st 17:00			16:45			16:30			
ie	5	29	0	223	4	0	9	239	0
tal	34			227			248		
	.68			.97			.96		

AUTOMATED COUNTS & TRAFFIC SURVEYS INC.  
 2 BURCHARD AVENUE  
 LITTLE COMPTON, RI 02837  
 (401)635-1650

Site Code : 03093001  
 Start Date: 09/30/03  
 File I.D. : GPIS0901  
 Page : 6

AUTOS, HEAVY VEHICLES

MILL ST Southbound			ROUTE 27 Westbound			ROUTE 27 Eastbound			Total
Left	Right	PEDS	Thru	Right	PEDS	Left	Thru	PEDS	
09/30/03									
Hour Analysis By Entire Intersection for the Period: 12:30 to 18:00 on 09/30/03									
start 16:30			16:30			16:30			
7	75	1	871	9	1	48	905	0	
8	90	1	99	1	0	5	95	0	
Total 83			881			953			
start 17:00			16:45			16:30			
5	29	0	223	4	0	9	239	0	
Total 34			227			248			
.61			.97			.96			

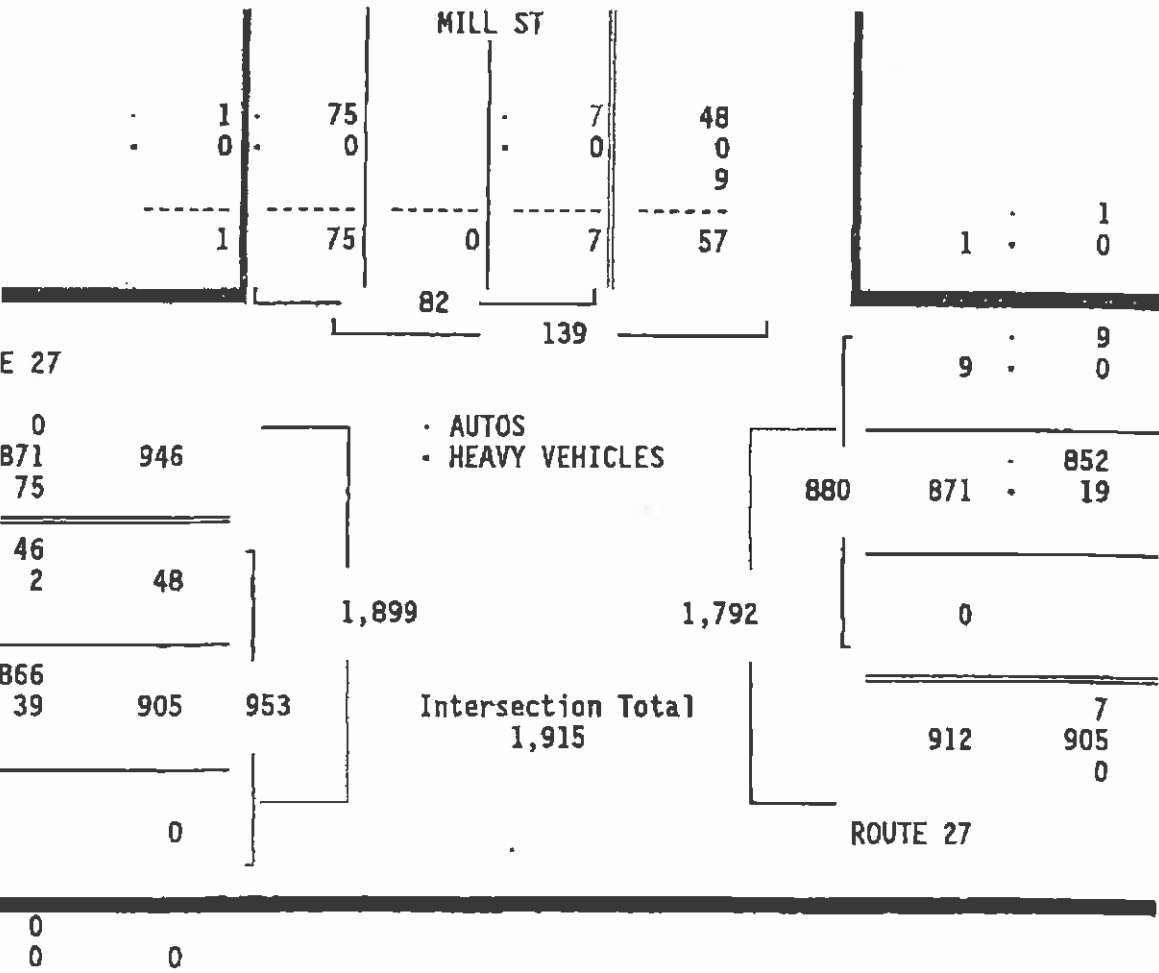

AUTOMATED COUNTS & TRAFFIC SURVEYS INC.  
 2 BURCHARD AVENUE  
 LITTLE COMPTON, RI 02837  
 (401)635-1650

Site Code : 03111901  
 Start Date: 11/19/03  
 File I.D. : GPIS115  
 Page : 1

ADTOS, HEAVY VEHICLES

TOSCA DR Southbound				CENTRAL ST Westbound				CANTON ST Northbound				CANTON ST Eastbound				Total	
Left	Thru	Right	PEDS	Left	Thru	Right	PEDS	Left	Thru	Right	PEDS	Left	Thru	Right	PEDS		
11/19/03																	
5	2	4	0	0	93	5	0	74	3	0	0	10	136	105	0	437	
1	2	3	1	1	136	11	0	88	3	0	0	17	163	105	0	531	
3	1	4	0	0	130	6	0	81	3	0	0	10	153	104	0	495	
1	2	4	0	0	127	11	0	83	7	0	0	10	169	112	0	526	
al	10	7	15	1	1	486	33	0	326	16	0	0	47	621	426	0	1989
2	4	2	0	0	126	21	0	81	2	0	0	12	185	131	0	566	
3	3	2	0	0	113	12	0	73	4	0	0	14	151	103	0	478	
5	0	7	1	0	126	14	0	91	5	1	0	17	148	112	0	527	
6	3	8	0	1	113	18	0	75	2	0	0	12	143	117	0	498	
al	16	10	19	1	1	478	65	0	320	13	1	0	55	627	463	0	2069
* BREAK *																	
5	5	18	0	0	163	4	0	87	2	1	0	6	102	137	0	530	
3	8	19	2	0	132	8	0	87	2	0	0	10	128	138	0	537	
4	7	16	0	0	155	5	0	73	2	0	0	12	132	117	0	523	
2	17	27	0	2	131	17	0	73	3	1	0	24	129	115	0	541	
al	14	37	80	2	2	581	34	0	320	9	2	0	52	491	507	0	2131
5	9	50	5	0	159	5	0	92	3	0	0	9	117	105	0	559	
4	4	13	0	1	158	2	0	81	2	1	0	4	133	141	0	544	
1	11	16	0	0	165	6	0	96	1	0	0	9	135	110	0	550	
2	7	16	0	0	149	10	0	82	7	2	0	24	125	122	0	546	
al	12	31	95	5	1	631	23	0	351	13	3	0	46	510	478	0	2199
* 52	85	209	9	5	2176	155	0	1317	51	6	0	200	2249	1874	0	8388	

AUTOMATED COUNTS & TRAFFIC SURVEYS INC.  
 2 BURCHARD AVENUE  
 LITTLE COMPTON, RI 02837  
 (401)635-1650

Site Code : 03111901  
 Start Date: 11/19/03  
 File I.D. : GPIS115  
 Page : 2

AUTOS, HEAVY VEHICLES

TOSCA DR Southbound				CENTRAL ST Westbound				CANTON ST Northbound				CANTON ST Eastbound				Total
Left	Thru	Right	PEDS	Left	Thru	Right	PEDS	Left	Thru	Right	PEDS	Left	Thru	Right	PEDS	
1/19/03																

TOSCA DR																																																							
				<table border="1" style="width: 100%;"> <tr><td>9</td><td>195</td><td>72</td><td>37</td></tr> <tr><td>0</td><td>14</td><td>13</td><td>15</td></tr> <tr><td colspan="4">-----</td></tr> <tr><td>9</td><td>209</td><td>85</td><td>52</td></tr> </table>				9	195	72	37	0	14	13	15	-----				9	209	85	52	<table border="1" style="width: 100%;"> <tr><td>200</td><td>51</td><td>155</td><td></td></tr> <tr><td colspan="4">-----</td></tr> <tr><td>406</td><td></td><td></td><td></td></tr> </table>				200	51	155		-----				406				<table border="1" style="width: 100%;"> <tr><td></td><td></td><td>0</td><td></td></tr> <tr><td>0</td><td></td><td>0</td><td></td></tr> </table>						0		0		0					
9	195	72	37																																																				
0	14	13	15																																																				
-----																																																							
9	209	85	52																																																				
200	51	155																																																					
-----																																																							
406																																																							
		0																																																					
0		0																																																					
				346																																																			
								752																																															

DN ST																																																																							
				<table border="1" style="width: 100%;"> <tr><td>317</td><td>176</td><td>3,702</td><td>209</td></tr> <tr><td colspan="4">-----</td></tr> <tr><td>186</td><td>14</td><td>200</td><td></td></tr> <tr><td colspan="4">-----</td></tr> <tr><td>4,323</td><td></td><td></td><td></td></tr> </table>				317	176	3,702	209	-----				186	14	200		-----				4,323				<table border="1" style="width: 100%;"> <tr><td>2,336</td><td>2,176</td><td>98</td><td></td></tr> <tr><td colspan="4">-----</td></tr> <tr><td>5</td><td></td><td>5</td><td></td></tr> <tr><td>5</td><td></td><td>0</td><td></td></tr> </table>				2,336	2,176	98		-----				5		5		5		0		<table border="1" style="width: 100%;"> <tr><td>139</td><td>16</td><td>2,078</td><td>98</td></tr> <tr><td colspan="4">-----</td></tr> <tr><td>52</td><td></td><td></td><td></td></tr> <tr><td>2,307</td><td>2,249</td><td>6</td><td></td></tr> </table>				139	16	2,078	98	-----				52				2,307	2,249	6					
317	176	3,702	209																																																																				
-----																																																																							
186	14	200																																																																					
-----																																																																							
4,323																																																																							
2,336	2,176	98																																																																					
-----																																																																							
5		5																																																																					
5		0																																																																					
139	16	2,078	98																																																																				
-----																																																																							
52																																																																							
2,307	2,249	6																																																																					
				8,025				4,643																																																															
								Intersection Total 8,379																																																															

CENTRAL ST																																																																			
				<table border="1" style="width: 100%;"> <tr><td>794</td><td>80</td><td>1,874</td><td></td></tr> <tr><td colspan="4">-----</td></tr> <tr><td>0</td><td></td><td>0</td><td></td></tr> <tr><td>0</td><td></td><td>0</td><td></td></tr> </table>				794	80	1,874		-----				0		0		0		0		<table border="1" style="width: 100%;"> <tr><td>1,374</td><td>1,245</td><td>42</td><td>6</td></tr> <tr><td>85</td><td>72</td><td>9</td><td>0</td></tr> <tr><td colspan="4">-----</td></tr> <tr><td>1,964</td><td>1,317</td><td>51</td><td>6</td></tr> </table>				1,374	1,245	42	6	85	72	9	0	-----				1,964	1,317	51	6	<table border="1" style="width: 100%;"> <tr><td></td><td></td><td>0</td><td></td></tr> <tr><td></td><td></td><td>0</td><td></td></tr> <tr><td colspan="4">-----</td></tr> <tr><td></td><td></td><td>0</td><td></td></tr> </table>						0				0		-----						0					
794	80	1,874																																																																	
-----																																																																			
0		0																																																																	
0		0																																																																	
1,374	1,245	42	6																																																																
85	72	9	0																																																																
-----																																																																			
1,964	1,317	51	6																																																																
		0																																																																	
		0																																																																	
-----																																																																			
		0																																																																	
				3,338				1,374																																																											
								CANTON ST																																																											

AUTOMATED COUNTS & TRAFFIC SURVEYS INC.  
 2 BURCHARD AVENUE  
 LITTLE COMPTON, RI 02837  
 (401)635-1650

Site Code : 03111901  
 Start Date: 11/19/03  
 File I.D. : GPIS115  
 Page : 3

SR : CLOUDY/WILD  
 SR : D-2616  
 SD by: RP  
 SITS: STOUGHTON

AUTOS, HEAVY VEHICLES

TOSCA DR Southbound					CENTRAL ST Westbound				CANTON ST Northbound				CANTON ST Eastbound				Total
Left	Thru	Right	PEDS		Left	Thru	Right	PEDS		Left	Thru	Right	PEDS				
11/19/03																	
Hour Analysis By Individual Approach for the Period: 07:00 to 12:30 on 11/19/03																	
start 08:00					07:15				07:15				07:15				
Left	16	10	19	1	1	519	49	0		333	15	0	0	49	670	452	0
Thru	35	22	41	2	0	91	9	0		96	4	0	0	4	57	39	0
Right	46				569					348				1171			
PEDS	08:45				07:15					07:15				08:00			
Total	6	3	8	0	1	136	11	0		88	3	0	0	12	185	131	0
Left	17				148					91				328			
Thru	.68				.96					.96				.89			

AUTOMATED COUNTS & TRAFFIC SURVEYS INC.  
 2 BURCHARD AVENUE  
 LITTLE COMPTON, RI 02837  
 (401)635-1650

Site Code : 03111901  
 Start Date: 11/19/03  
 File I.D. : GPIS115  
 Page : 4

AUTOS, HEAVY VEHICLES

FOSCA DR Southbound				CENTRAL ST Westbound				CANTON ST Northbound				CANTON ST Eastbound				Total
Left	Thru	Right	PEDS	Left	Thru	Right	PEDS	Left	Thru	Right	PEDS	Left	Thru	Right	PEDS	

11/19/03

Hour Analysis By Entire Intersection for the Period: 07:00 to 12:30 on 11/19/03

start 07:15				07:15				07:15				07:15			
Left	Thru	Right	PEDS	Left	Thru	Right	PEDS	Left	Thru	Right	PEDS	Left	Thru	Right	PEDS
7	9	13	1	1	519	49	0	333	15	0	0	49	670	452	0
23	30	43	3	0	91	9	0	96	4	0	0	4	57	39	0
Total 30				569				348				1171			
start 07:30				07:15				07:15				08:00			
Left	Thru	Right	PEDS	Left	Thru	Right	PEDS	Left	Thru	Right	PEDS	Left	Thru	Right	PEDS
3	1	4	0	1	136	11	0	88	3	0	0	12	185	131	0
Total 8				148				91				328			
.94				.96				.96				.89			

TOSCA DR					
1	8	5	3	49	
0	5	4	4	15	
				49	
-----		-----		-----	
1	13	9	7	113	
-----		-----		-----	
29		142			

ON ST		CENTRAL ST	
333		49	47
519	865	49	2
13		-----	
48		-----	
1	49	-----	
-----		-----	
2,036		-----	
-----		-----	
569		-----	
519		-----	
13		-----	
48		-----	
1		-----	
-----		-----	
1,246		-----	
-----		-----	
635		-----	
35	670	-----	
1,171		-----	
-----		-----	
426		-----	
26	452	-----	
-----		-----	
0		-----	
0	0	-----	

Intersection Total					
2,117					
-----					
677					
-----					
7					
-----					
670					
-----					
0					

CENTRAL ST					
1	305	13	0	0	
9	28	2	0	0	
-----		-----		-----	
452					
-----		-----		-----	
462	333	15	0	0	



AUTOMATED COUNTS & TRAFFIC SURVEYS INC.  
 2 BURCHARD AVENUE  
 LITTLE COMPTON, RI 02837  
 (401)635-1650

Site Code : 03111901  
 Start Date: 11/19/03  
 File I.D. : GPIS115  
 Page : 5

AUTOS, HEAVY VEHICLES

TOSCA DR Southbound					CENTRAL ST Westbound				CANTON ST Northbound				CANTON ST Eastbound				Total		
Left	Thru	Right	PEDS		Left	Thru	Right	PEDS		Left	Thru	Right	PEDS		Left	Thru		Right	PEDS
11/19/03																			
Hour Analysis By Individual Approach for the Period: 12:30 to 18:00 on 11/19/03																			
start 16:15					17:00				17:00				16:00						
ave	14	41	112	7	1	631	23	0		351	13	3	0		52	491	507	0	
ent	8%	24%	64%	4%	0%	96%	4%	0%		96%	4%	1%	0%		5%	47%	48%	0%	
total	174				655					367					1050				
est	17:00				17:30					17:30					16:15				
ave	5	9	50	5	0	165	6	0		96	1	0	0		10	128	138	0	
total	69				171					97					276				
	.63				.96					.95					.95				

AUTOMATED COUNTS & TRAFFIC SURVEYS INC.  
 2 BURCHARD AVENUE  
 LITTLE COMPTON, RI 02837  
 (401)635-1650

Site Code : 03111901  
 Start Date: 11/19/03  
 File I.D. : GPIS115  
 Page : 6

ier : CLOUDY/HILD  
 er : D-2616  
 ed by: RT  
 nts: STOUGHTON

AUTOS, HEAVY VEHICLES

TOSCA DR Southbound					CENTRAL ST Westbound				CANTON ST Northbound				CANTON ST Eastbound				Total		
Left	Thru	Right	PEDS		Left	Thru	Right	PEDS		Left	Thru	Right	PEDS		Left	Thru		Right	PEDS
11/19/03																			
Hour Analysis By Entire Intersection for the Period: 12:30 to 18:00 on 11/19/03																			
start 17:00					17:00				17:00				17:00						
ie	12	31	95	5	1	631	23	0		351	13	3	0		46	510	478	0	
nt	8	22	66	3	0	96	4	0		96	4	1	0		4	49	46	0	
tal	143				655					367					1034				
start 17:00					17:30				17:30				17:15						
ie	5	9	50	5	0	165	6	0		96	1	0	0		4	133	141	0	
tal	69				171					97					278				
	.52				.96					.95					.93				

TOSCA DR				
5	94	28	12	46
0	1	3	0	13
				23
5	95	31	12	82
138		220		

TOSCA DR		CENTRAL ST		CANTON ST	
351	631	1,077	44	2	46
95			2,111		
44	2	46			
493	17	510	1,034		
466	12	478			
0	0		877		
0	0		367		

Intersection Total				
2,111	1,180	655	631	12
1,034	525	12	510	3
2,194				
1,034				
877	367			
1	346	13	3	0
31	5	0	0	0
478				
510	351	13	3	0

AUTOMATED COUNTS & TRAFFIC SURVEYS INC.  
 2 BURCHARD AVENUE  
 LITTLE COMPTON, RI 02837  
 (401)635-1650

Site Code : 03111901  
 Start Date: 11/19/03  
 File I.D. : GPIS115  
 Page : 1

AUTOS

TOSCA DR Southbound				CENTRAL ST Westbound				CANTON ST Northbound				CANTON ST Eastbound				Total	
Left	Thru	Right	PEDS	Left	Thru	Right	PEDS	Left	Thru	Right	PEDS	Left	Thru	Right	PEDS		
11/19/03																	
2	1	3	0	0	82	5	0	64	3	0	0	10	132	97	0	399	
1	1	2	1	1	124	11	0	81	2	0	0	17	151	100	0	492	
2	1	2	0	0	126	6	0	76	3	0	0	10	152	100	0	478	
0	1	3	0	0	120	11	0	78	6	0	0	9	161	104	0	493	
al	5	4	10	1	1	452	33	0	299	14	0	0	46	596	401	0	1862
0	2	1	0	0	120	19	0	70	2	0	0	12	171	122	0	519	
2	2	2	0	0	104	10	0	66	3	0	0	14	145	99	0	447	
3	0	4	1	0	117	13	0	86	4	1	0	15	139	109	0	492	
3	1	8	0	1	99	15	0	67	1	0	0	11	136	113	0	455	
al	8	5	15	1	1	440	57	0	289	10	1	0	52	591	443	0	1913
* BREAK *																	
4	5	17	0	0	156	3	0	84	1	1	0	5	97	131	0	504	
3	6	18	2	0	130	6	0	85	1	0	0	10	123	129	0	513	
3	7	15	0	0	152	4	0	71	1	0	0	5	124	115	0	497	
2	17	26	0	2	129	15	0	71	2	1	0	24	120	109	0	518	
al	12	35	76	2	2	567	28	0	311	5	2	0	44	464	484	0	2032
5	8	50	5	0	159	4	0	88	3	0	0	9	110	98	0	539	
4	3	13	0	1	152	2	0	81	2	1	0	4	130	139	0	532	
1	11	16	0	0	162	5	0	95	1	0	0	8	132	109	0	540	
2	6	15	0	0	146	10	0	82	7	2	0	23	121	120	0	534	
al	12	28	94	5	1	619	21	0	346	13	3	0	44	493	466	0	2145
* 37 72 195 9   5 2078 139 0   1245 42 6 0   186 2144 1794 0   7952																	



AUTOMATED COUNTS & TRAFFIC SURVEYS INC.  
 2 BURCHARD AVENUE  
 LITTLE COMPTON, RI 02837  
 (401)635-1650

Site Code : 03111901  
 Start Date: 11/19/03  
 File I.D. : GPIS115  
 Page : 1

HEAVY VEHICLES

FOSCA DR Southbound				CENTRAL ST Westbound				CANTON ST Northbound				CANTON ST Eastbound				Total	
Left	Thru	Right	Other	Left	Thru	Right	Other	Left	Thru	Right	Other	Left	Thru	Right	Other		
1/19/03																	
3	1	1	0	0	11	0	0	10	0	0	0	0	4	8	0	38	
0	1	1	0	0	12	0	0	7	1	0	0	0	12	5	0	39	
1	0	2	0	0	4	0	0	5	0	0	0	0	1	4	0	17	
1	1	1	0	0	7	0	0	5	1	0	0	1	8	8	0	33	
al	5	3	5	0	0	34	0	0	27	2	0	0	1	25	25	0	127
2	2	1	0	0	6	2	0	11	0	0	0	0	14	9	0	47	
1	1	0	0	0	9	2	0	7	1	0	0	0	6	4	0	31	
2	0	3	0	0	9	1	0	5	1	0	0	2	9	3	0	35	
3	2	0	0	0	14	3	0	8	1	0	0	1	7	4	0	43	
al	8	5	4	0	0	38	8	0	31	3	0	0	3	36	20	0	156
* BREAK *																	
1	0	1	0	0	7	1	0	3	1	0	0	1	5	6	0	26	
0	2	1	0	0	2	2	0	2	1	0	0	0	5	9	0	24	
1	0	1	0	0	3	1	0	2	1	0	0	7	8	2	0	26	
0	0	1	0	0	2	2	0	2	1	0	0	0	9	6	0	23	
al	2	2	4	0	0	14	6	0	9	4	0	0	8	27	23	0	99
0	1	0	0	0	0	1	0	4	0	0	0	0	7	7	0	20	
0	1	0	0	0	6	0	0	0	0	0	0	0	3	2	0	12	
0	0	0	0	0	3	1	0	1	0	0	0	1	3	1	0	10	
0	1	1	0	0	3	0	0	0	0	0	0	1	4	2	0	12	
al	0	3	1	0	0	12	2	0	5	0	0	0	2	17	12	0	54
* 15	13	14	0	0	98	16	0	72	9	0	0	14	105	80	0	436	



AUTOMATED COUNTS & TRAFFIC SURVEYS INC.  
 2 BURCHARD AVENUE  
 LITTLE COMPTON, RI 02837  
 (401)635-1650

Site Code : 03111902  
 Start Date: 11/19/03  
 File I.D. : GPIS116  
 Page : 1

er : CLOUDY/MILD  
 er : D-2613  
 ed by: SCS  
 nts: STOUGHTON

AUTOS, HEAVY VEHICLES

PRATT CT Southbound				CANTON ST Westbound				PRATT CT Northbound				CANTON ST Eastbound				Total	
Left	Thru	Right	PEDS	Left	Thru	Right	PEDS	Left	Thru	Right	PEDS	Left	Thru	Right	PEDS		
11/19/03																	
0	2	0	0	2	0	1	0	1	2	2	0	1	0	1	0	12	
0	2	0	0	4	0	3	1	0	2	4	0	0	0	1	0	17	
0	0	0	0	1	0	3	0	3	2	3	0	0	0	2	1	15	
0	0	0	0	0	0	10	0	0	0	1	2	1	0	0	0	14	
tal	0	4	0	0	7	0	17	1	4	6	10	2	2	0	4	1	58
2	1	0	0	1	0	9	0	0	1	4	0	0	0	1	0	19	
0	1	0	0	1	0	4	0	2	4	1	0	1	0	0	0	14	
1	0	0	0	1	0	10	0	1	0	4	0	0	0	1	0	18	
0	0	0	0	1	0	3	0	0	3	1	0	2	0	0	0	10	
tal	3	2	0	0	4	0	26	0	3	8	10	0	3	0	2	0	61
* BREAK *																	
3	1	0	0	2	0	0	0	0	1	1	0	0	0	0	0	8	
4	0	0	0	3	0	3	0	0	0	1	0	0	0	1	0	12	
3	1	0	0	1	0	1	0	1	1	4	1	0	0	0	0	13	
6	1	1	0	1	0	3	0	0	0	2	0	0	0	3	0	17	
tal	16	3	1	0	7	0	7	0	1	2	8	1	0	0	4	0	50
6	0	0	0	4	0	0	0	0	1	5	1	1	0	5	0	23	
4	1	0	0	4	0	0	0	1	0	0	0	0	0	3	0	13	
3	3	0	0	4	0	3	0	1	5	3	0	0	0	3	0	25	
3	0	1	0	3	0	2	0	1	1	3	0	0	0	1	0	15	
tal	16	4	1	0	15	0	5	0	3	7	11	1	1	0	12	0	76
tal	35	13	2	0	33	0	55	1	11	23	39	4	6	0	22	1	245





AUTOMATED COUNTS & TRAFFIC SURVEYS INC.  
 2 BORCHARD AVENUE  
 LITTLE COMPTON, RI 02837  
 (401)635-1650

Site Code : 03111902  
 Start Date: 11/19/03  
 File I.D. : GPIS116  
 Page : 3

her : CLOUDY/MILD  
 ter : D-2613  
 ted by: SCS  
 ents: STOUGHTON

AUTOS, HEAVY VEHICLES

PRATT CT Southbound					CANTON ST Westbound				PRATT CT Northbound				CANTON ST Eastbound				Total
Left	Thru	Right	PEDS		Left	Thru	Right	PEDS	Left	Thru	Right	PEDS	Left	Thru	Right	PEDS	
11/19/03																	
Hour Analysis By Individual Approach for the Period: 07:00 to 12:30 on 11/19/03																	
start 07:45					07:45				07:30				07:00				
ave	3	2	0	0	3	0	33	0	5	7	9	2	2	0	4	1	
ent	60%	40%	0%	0%	8%	0%	92%	0%	22%	30%	39%	9%	29%	0%	57%	14%	
otal	5				36				23				7				
start 08:00					08:30				07:30				07:30				
ave	2	1	0	0	1	0	10	0	3	2	3	0	0	0	2	1	
otal	3				11				8				3				
	.42				.82				.72				.58				

AUTOMATED COUNTS & TRAFFIC SURVEYS INC.  
 2 BURCHARD AVENUE  
 LITTLE COMPTON, RI 02837  
 (401)635-1650

Site Code : 03111902  
 Start Date: 11/19/03  
 File I.D. : GPIS116  
 Page : 4

AUTOS, HEAVY VEHICLES

PRATT CT Southbound					CANTON ST Westbound				PRATT CT Northbound				CANTON ST Eastbound				Total
Left	Thru	Right	PEDS		Left	Thru	Right	PEDS	Left	Thru	Right	PEDS	Left	Thru	Right	PEDS	
11/19/03																	
Hour Analysis By Entire Intersection for the Period: 07:00 to 12:30 on 11/19/03																	
start 07:45					07:45				07:45				07:45				
3	2	0	0		3	0	33	0	3	5	10	2	2	0	2	0	
60%	40%	0%	0%		8%	0%	92%	0%	15%	25%	50%	10%	50%	0%	50%	0%	
Total 5					36				20				4				
start 08:00					08:30				08:15				07:45				
2	1	0	0		1	0	10	0	2	4	1	0	1	0	0	0	
Total 3					11				7				1				
.42					.82				.71				1.00				

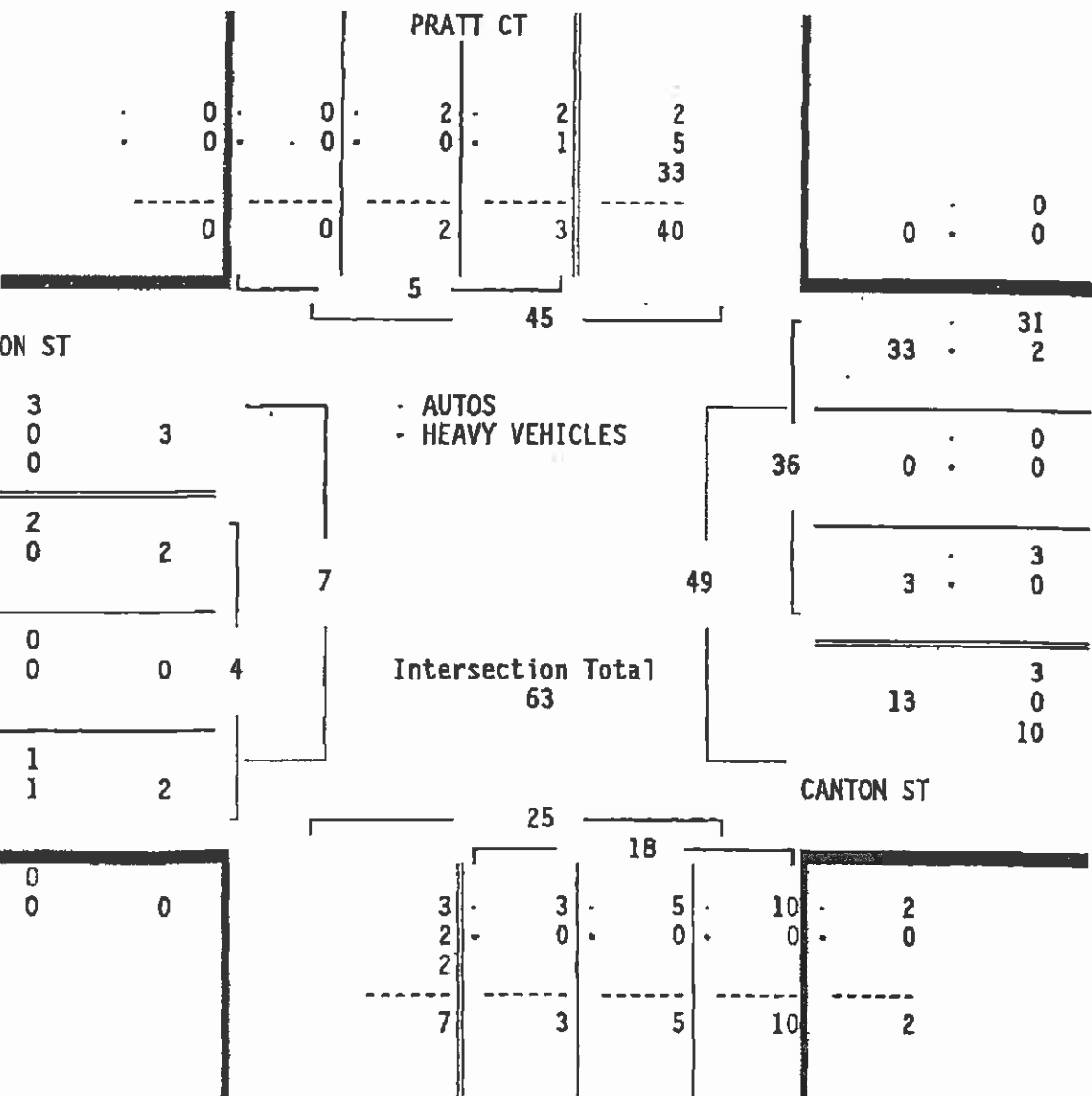

AUTOMATED COUNTS & TRAFFIC SURVEYS INC.  
 2 BURCHARD AVENUE  
 LITTLE COMPTON, RI 02837  
 (401)635-1650

Site Code : 03111902  
 Start Date: 11/19/03  
 File I.D. : GPIS116  
 Page : 5

er : CLOUDY/MILD  
 er : D-2613  
 ed by: SCS  
 ts: STOUGHTON

AUTOS, HEAVY VEHICLES

PRATT CT Southbound				CANTON ST Westbound				PRATT CT Northbound				CANTON ST Eastbound				Total
Left	Thru	Right	PEDS	Left	Thru	Right	PEDS	Left	Thru	Right	PEDS	Left	Thru	Right	PEDS	
11/19/03																
Hour Analysis By Individual Approach for the Period: 12:30 to 18:00 on 11/19/03																
start 16:45				17:00				17:00				16:45				
19	5	1	0	15	0	5	0	3	7	11	1	1	0	14	0	
76%	20%	4%	0%	75%	0%	25%	0%	14%	32%	50%	5%	7%	0%	93%	0%	
total 25				20				22				15				
start 16:45				17:30				17:30				17:00				
6	1	1	0	4	0	3	0	1	5	3	0	1	0	5	0	
total 8				7				9				6				
.78				.71				.61				.62				

AUTOMATED COUNTS & TRAFFIC SURVEYS INC.  
 2 BURCHARD AVENUE  
 LITTLE COMPTON, RI 02837  
 (401)635-1650

Site Code : 03111902  
 Start Date: 11/19/03  
 File I.D. : GPIS116  
 Page : 6

AUTOS, HEAVY VEHICLES

PRATT CT Southbound				CANTON ST Westbound				PRATT CT Northbound				CANTON ST Eastbound				Total
Left	Thru	Right	PEDS	Left	Thru	Right	PEDS	Left	Thru	Right	PEDS	Left	Thru	Right	PEDS	
11/19/03																
Hour Analysis By Entire Intersection for the Period: 12:30 to 18:00 on 11/19/03																
Start 16:45				16:45				16:45				16:45				
19	5	1	0	13	0	6	0	2	6	10	1	1	0	14	0	
76%	20%	4%	0%	68%	0%	32%	0%	11%	32%	53%	5%	7%	0%	93%	0%	
Total 25				19				19				15				
Start 16:45				17:30				17:30				17:00				
6	1	1	0	4	0	3	0	1	5	3	0	1	0	5	0	
Total 8				7				9				6				
.75				.68				.53				.62				

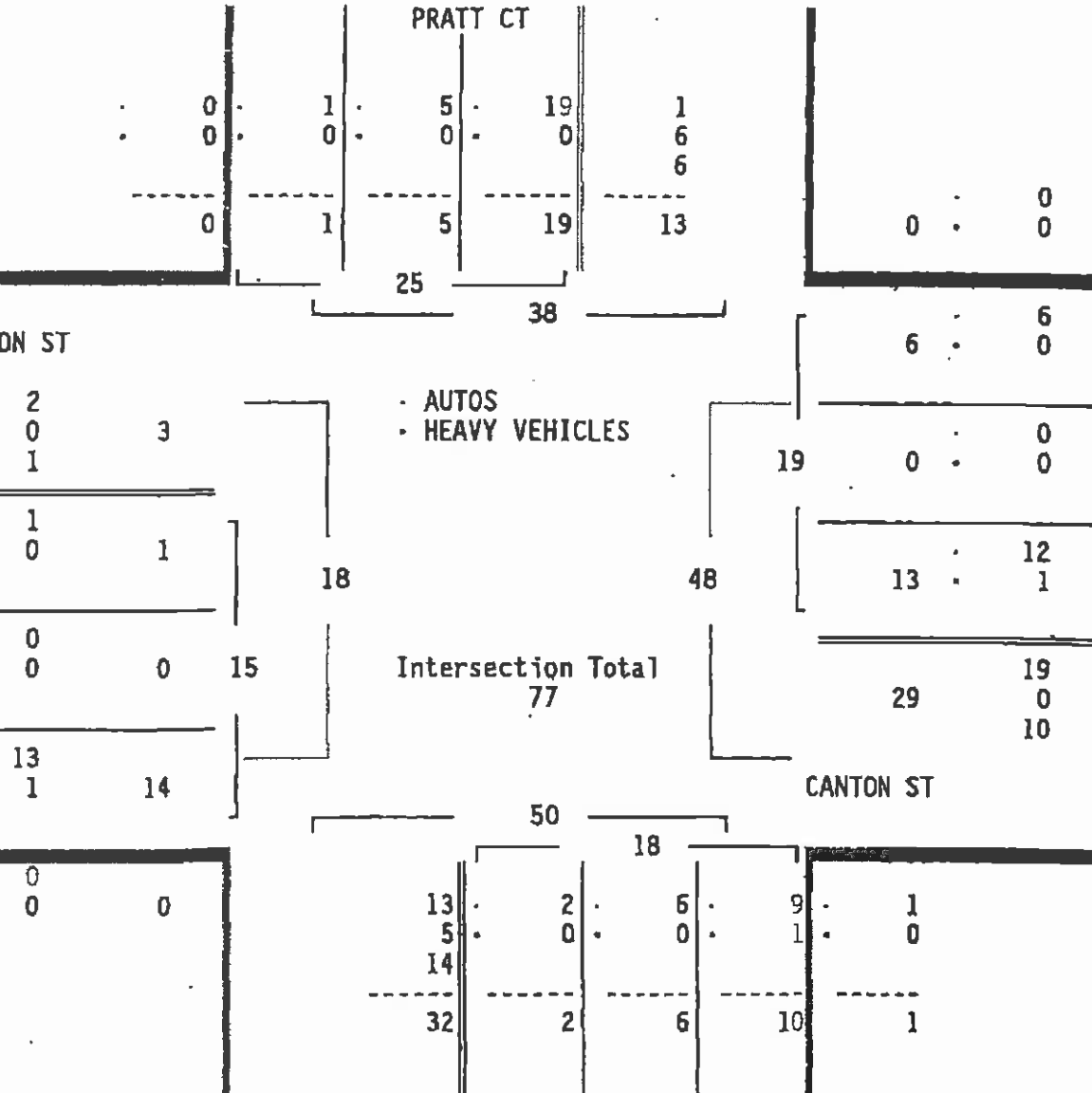

AUTOMATED COUNTS & TRAFFIC SURVEYS INC.  
 2 BURCHARD AVENUE  
 LITTLE COMPTON, RI 02837  
 (401)635-1650

Site Code : 03111902  
 Start Date: 11/19/03  
 File I.D. : GPIS116  
 Page : 1

AUTOS

PRATT CT Southbound				CANTON ST Westbound				PRATT CT Northbound				CANTON ST Eastbound				Total	
Left	Thru	Right	PEDS	Left	Thru	Right	PEDS	Left	Thru	Right	PEDS	Left	Thru	Right	PEDS		
11/19/03																	
0	2	0	0	2	0	1	0	1	2	2	0	1	0	1	0	12	
0	2	0	0	4	0	3	1	0	2	3	0	0	0	0	0	15	
0	0	0	0	1	0	2	0	3	2	3	0	0	0	2	1	14	
0	0	0	0	0	0	8	0	0	0	1	2	1	0	0	0	12	
<b>tal</b>	0	4	0	0	7	0	14	1	4	6	9	2	2	0	3	1	53
1	1	0	0	1	0	9	0	0	1	4	0	0	0	0	0	17	
0	1	0	0	1	0	4	0	2	4	1	0	1	0	0	0	14	
1	0	0	0	1	0	10	0	1	0	4	0	0	0	1	0	18	
0	0	0	0	1	0	3	0	0	3	1	0	2	0	0	0	10	
<b>tal</b>	2	2	0	0	4	0	26	0	3	8	10	0	3	0	1	0	59
* BREAK *																	
2	1	0	0	2	0	0	0	0	1	1	0	0	0	0	0	7	
4	0	0	0	3	0	3	0	0	0	1	0	0	0	1	0	12	
3	1	0	0	1	0	1	0	1	1	3	1	0	0	0	0	12	
6	1	1	0	1	0	3	0	0	0	2	0	0	0	2	0	16	
<b>tal</b>	15	3	1	0	7	0	7	0	1	2	7	1	0	0	3	0	47
6	0	0	0	3	0	0	0	0	1	4	1	1	0	5	0	21	
4	1	0	0	4	0	0	0	1	0	0	0	0	0	3	0	13	
3	3	0	0	4	0	3	0	1	5	3	0	0	0	3	0	25	
3	0	1	0	3	0	2	0	1	1	3	0	0	0	1	0	15	
<b>tal</b>	16	4	1	0	14	0	5	0	3	7	10	1	1	0	12	0	74
<b>tal</b>	33	13	2	0	32	0	52	1	11	23	36	4	6	0	19	1	233



AUTOMATED COUNTS & TRAFFIC SURVEYS INC.  
 2 BURCHARD AVENUE  
 LITTLE COMPTON, RI 02837  
 (401)635-1650

Site Code : 03111902  
 Start Date: 11/19/03  
 File I.D. : GPIS116  
 Page : 1

er : CLOUDY/MILD  
 er : D-2613  
 ed by: SCS  
 nts: STOUGHTON

HEAVY VEHICLES

PRATT CT Southbound				CANTON ST Westbound				PRATT CT Northbound				CANTON ST Eastbound				Total
Left	Thru	Right	Other	Left	Thru	Right	Other	Left	Thru	Right	Other	Left	Thru	Right	Other	
11/19/03																
0	0	0	0	0	0	0	0	0	0	0	0	0	0	0	0	0
0	0	0	0	0	0	0	0	0	0	1	0	0	0	1	0	2
0	0	0	0	0	0	1	0	0	0	0	0	0	0	0	0	1
0	0	0	0	0	0	2	0	0	0	0	0	0	0	0	0	2
<b>tal</b>	0	0	0	0	0	3	0	0	0	1	0	0	0	1	0	5
1	0	0	0	0	0	0	0	0	0	0	0	0	0	1	0	2
0	0	0	0	0	0	0	0	0	0	0	0	0	0	0	0	0
0	0	0	0	0	0	0	0	0	0	0	0	0	0	0	0	0
0	0	0	0	0	0	0	0	0	0	0	0	0	0	0	0	0
<b>tal</b>	1	0	0	0	0	0	0	0	0	0	0	0	0	1	0	2
----- † BREAK † -----																
1	0	0	0	0	0	0	0	0	0	0	0	0	0	0	0	1
0	0	0	0	0	0	0	0	0	0	0	0	0	0	0	0	0
0	0	0	0	0	0	0	0	0	0	1	0	0	0	0	0	1
0	0	0	0	0	0	0	0	0	0	0	0	0	0	1	0	1
<b>tal</b>	1	0	0	0	0	0	0	0	0	1	0	0	0	1	0	3
0	0	0	0	1	0	0	0	0	0	1	0	0	0	0	0	2
0	0	0	0	0	0	0	0	0	0	0	0	0	0	0	0	0
0	0	0	0	0	0	0	0	0	0	0	0	0	0	0	0	0
0	0	0	0	0	0	0	0	0	0	0	0	0	0	0	0	0
<b>tal</b>	0	0	0	1	0	0	0	0	0	1	0	0	0	0	0	2
----- † BREAK † -----																
<b>tal</b>	2	0	0	1	0	3	0	0	0	3	0	0	0	3	0	12





AUTOMATED COUNTS & TRAFFIC SURVEYS INC.  
 2 BURCHARD AVENUE  
 LITTLE COMPTON, RI 02837  
 (401)635-1650

Site Code : 03111903  
 Start Date: 11/19/03  
 File I.D. : GPIS117  
 Page : 1

AUTOS, HEAVY VEHICLES

DRIVEWAY Southbound				CENTRAL ST Westbound				PRAATT CT EXT Northbound				CENTRAL ST Eastbound				Total	
Left	Thru	Right	PEDS	Left	Thru	Right	PEDS	Left	Thru	Right	PEDS	Left	Thru	Right	PEDS		
11/19/03																	
1	0	0	0	2	0	0	0	1	0	3	0	3	0	0	0	10	
0	0	0	0	2	0	0	0	2	0	2	1	0	0	0	0	7	
0	0	1	0	0	0	0	0	1	0	5	0	1	0	0	0	8	
0	0	0	0	0	0	0	0	5	0	6	0	2	0	0	0	13	
<b>tal</b>	<b>1</b>	<b>0</b>	<b>1</b>	<b>0</b>	<b>4</b>	<b>0</b>	<b>0</b>	<b>0</b>	<b>9</b>	<b>0</b>	<b>16</b>	<b>1</b>	<b>6</b>	<b>0</b>	<b>0</b>	<b>0</b>	<b>38</b>
0	0	0	0	3	0	2	0	7	0	3	0	0	0	0	0	15	
0	0	0	0	1	0	0	0	2	0	7	0	2	0	0	0	12	
2	0	0	1	1	0	0	0	5	1	3	0	4	0	0	0	17	
4	0	0	0	0	0	0	0	3	0	5	0	0	0	0	0	12	
<b>tal</b>	<b>6</b>	<b>0</b>	<b>0</b>	<b>1</b>	<b>5</b>	<b>0</b>	<b>2</b>	<b>0</b>	<b>17</b>	<b>1</b>	<b>18</b>	<b>0</b>	<b>6</b>	<b>0</b>	<b>0</b>	<b>0</b>	<b>56</b>
* BREAK *																	
0	0	0	0	2	0	1	0	0	0	1	0	0	0	2	0	6	
1	1	1	2	2	0	0	0	1	0	2	0	2	0	1	0	13	
1	0	2	0	3	0	0	0	0	0	2	0	0	0	1	0	9	
1	1	2	0	5	0	0	0	2	0	1	0	0	0	2	0	14	
<b>tal</b>	<b>3</b>	<b>2</b>	<b>5</b>	<b>2</b>	<b>12</b>	<b>0</b>	<b>1</b>	<b>0</b>	<b>3</b>	<b>0</b>	<b>6</b>	<b>0</b>	<b>2</b>	<b>0</b>	<b>6</b>	<b>0</b>	<b>42</b>
1	0	3	0	4	0	0	0	0	0	2	0	0	0	3	0	13	
0	1	0	0	3	0	0	0	0	0	0	0	0	0	0	0	4	
0	0	0	0	6	0	0	0	0	0	8	0	0	0	0	0	14	
0	0	0	0	2	0	0	0	0	0	3	0	0	0	2	0	7	
<b>tal</b>	<b>1</b>	<b>1</b>	<b>3</b>	<b>0</b>	<b>15</b>	<b>0</b>	<b>0</b>	<b>0</b>	<b>0</b>	<b>0</b>	<b>13</b>	<b>0</b>	<b>0</b>	<b>0</b>	<b>5</b>	<b>0</b>	<b>38</b>
<b>tal</b>	<b>11</b>	<b>3</b>	<b>9</b>	<b>3</b>	<b>36</b>	<b>0</b>	<b>3</b>	<b>0</b>	<b>29</b>	<b>1</b>	<b>53</b>	<b>1</b>	<b>14</b>	<b>0</b>	<b>11</b>	<b>0</b>	<b>174</b>

AUTOMATED COUNTS & TRAFFIC SURVEYS INC.  
 2 BURCHARD AVENUE  
 LITTLE COMPTON, RI 02837  
 (401)635-1650

Site Code : 03111903  
 Start Date: 11/19/03  
 File I.D. : GPIS117  
 Page : 2

AUTOS, HEAVY VEHICLES

DRIVEWAY				CENTRAL ST Westbound				PRATT CT EXT Northbound				CENTRAL ST Eastbound				Total
Left	Thru	Right	PEDS	Left	Thru	Right	PEDS	Left	Thru	Right	PEDS	Left	Thru	Right	PEDS	
11/19/03																

DRIVEWAY																
				9	3		10		14							
				0	0		1		1							
				-----		-----		3								
				3	9		11		18				0			
				23		41						0				

CENTRAL ST															
				38		14		39				3			
				13		1		103				0			
				0		0		63				0			
				11		11		103				34			
				0		0		25				2			
				0		0		170				11			
				0		0		170				0			
				11		11		170				53			

PRATT CT EXT																	
				36		29		1		50				1			
				3		0		0		3				0			
				11		-----		-----		-----				-----			
				50		29		1		53				1			

AUTOMATED COUNTS & TRAFFIC SURVEYS INC.  
 2 BURCHARD AVENUE  
 LITTLE COMPTON, RI 02837  
 (401)635-1650

Site Code : 03111903  
 Start Date: 11/19/03  
 File I.D. : GPIS117  
 Page : 3

AUTOS, HEAVY VEHICLES

DRIVEWAY Southbound					CENTRAL ST Westbound				PRATT CT EXT Northbound				CENTRAL ST Eastbound				Total	
Left	Thru	Right	PEDS		Left	Thru	Right	PEDS		Left	Thru	Right	PEDS					
11/19/03																		
Hour Analysis By Individual Approach for the Period: 07:00 to 12:30 on 11/19/03																		
start 08:00					07:45				07:45				07:45					
ie	6	0	0	1	5	0	2	0	19	1	19	0	8	0	0	0		
nt	86%	0%	0%	14%	71%	0%	29%	0%	49%	3%	49%	0%	100%	0%	0%	0%		
ital	7				7				39				8					
st	08:45					08:00				07:45				08:30				
ie	4	0	0	0	3	0	2	0	5	0	6	0	4	0	0	0		
ital	4				5				11				4					
	.44				.35				.89				.50					

AUTOMATED COUNTS & TRAFFIC SURVEYS INC.  
 2 BURCHARD AVENUE  
 LITTLE COMPTON, RI 02837  
 (401)635-1650

Site Code : 03111903  
 Start Date: 11/19/03  
 File I.D. : GPIS117  
 Page : 4

AUTOS, HEAVY VEHICLES

DRIVEWAY Southbound				CENTRAL ST Westbound				PRATT CT EXT. Northbound				CENTRAL ST Eastbound				Total
Left	Thru	Right	PEDS	Left	Thru	Right	PEDS	Left	Thru	Right	PEDS	Left	Thru	Right	PEDS	

11/19/03

Hour Analysis By Entire Intersection for the Period: 07:00 to 12:30 on 11/19/03

start 07:45				07:45				07:45				07:45				Total
Left	Thru	Right	PEDS	Left	Thru	Right	PEDS	Left	Thru	Right	PEDS	Left	Thru	Right	PEDS	
2	0	0	1	5	0	2	0	19	1	19	0	8	0	0	0	
67%	0%	0%	33%	71%	0%	29%	0%	49%	3%	49%	0%	100%	0%	0%	0%	
3				7				39				8				
start 08:30				08:00				07:45				08:30				Total
2	0	0	1	3	0	2	0	5	0	6	0	4	0	0	0	
3				5				11				4				
.25				.35				.89				.50				

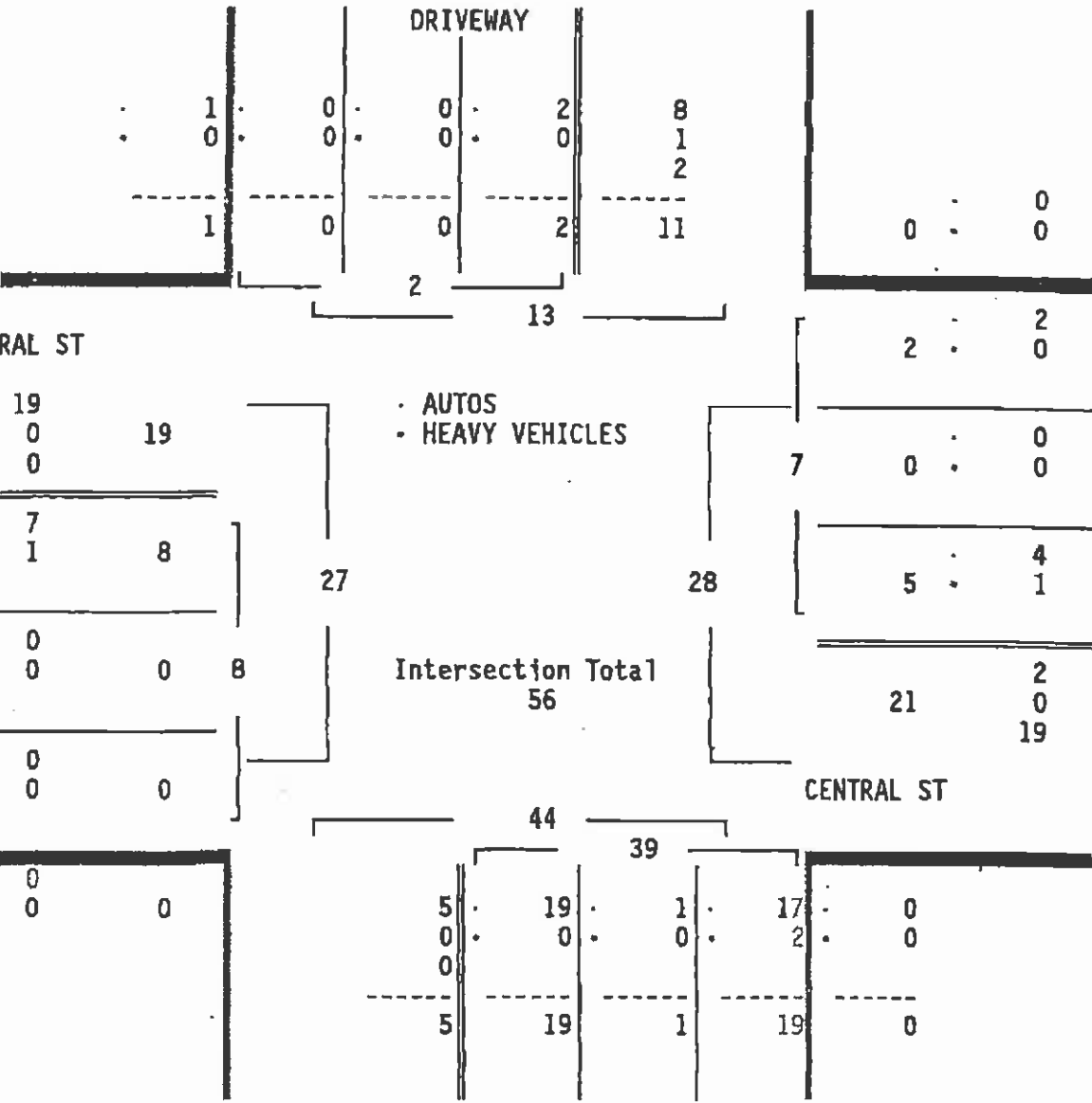

AUTOMATED COUNTS & TRAFFIC SURVEYS INC.  
 2 BURCHARD AVENUE  
 LITTLE COMPTON, RI 02837  
 (401)635-1650

Site Code : 03111903  
 Start Date: 11/19/03  
 File I.D. : GPIS117  
 Page : 5

AUTOS, HEAVY VEHICLES

DRIVEWAY Southbound	CENTRAL ST Westbound				PRATT CT EXT Northbound				CENTRAL ST Eastbound				Total			
	Left	Thru	Right	PEDS	Left	Thru	Right	PEDS	Left	Thru	Right	PEDS				
11/19/03																
Hour Analysis By Individual Approach for the Period: 12:30 to 18:00 on 11/19/03																
Start 16:15	16:45				17:00				16:15							
Left	4	2	8	2	18	0	0	0	0	0	13	0	2	0	7	0
Thru	25	12	50	12	100	0	0	0	0	0	100	0	22	0	78	0
Right	16				18				13				9			
Start 16:15	17:30				17:30				16:15							
Left	1	1	1	2	6	0	0	0	0	0	8	0	2	0	1	0
Thru	5				6				8				3			
Right	.80				.75				.41				.75			

AUTOMATED COUNTS & TRAFFIC SURVEYS INC.  
 2 BURCHARD AVENUE  
 LITTLE COMPTON, RI 02837  
 (401)635-1650

Site Code : 03111903  
 Start Date: 11/19/03  
 File I.D. : GPIS117  
 Page : 6

AUTOS, HEAVY VEHICLES

DRIVEWAY Southbound				CENTRAL ST Westbound				PRATT CT EXT Northbound				CENTRAL ST Eastbound				Total
Left	Thru	Right	PEDS	Left	Thru	Right	PEDS	Left	Thru	Right	PEDS	Left	Thru	Right	PEDS	

11/19/03

Hour Analysis By Entire Intersection for the Period: 12:30 to 18:00 on 11/19/03

start 16:15				16:15				16:15				16:15				
e	4	2	8	2	14	0	0	0	3	0	7	0	2	0	7	0
nt	25	12	50	12	100	0	0	0	30	0	70	0	22	0	78	0
tal	16				14				10				9			
st	16:15				16:45				16:15				16:15			
e	1	1	1	2	5	0	0	0	1	0	2	0	2	0	1	0
tal	5				5				3				3			
	.80				.70				.83				.75			

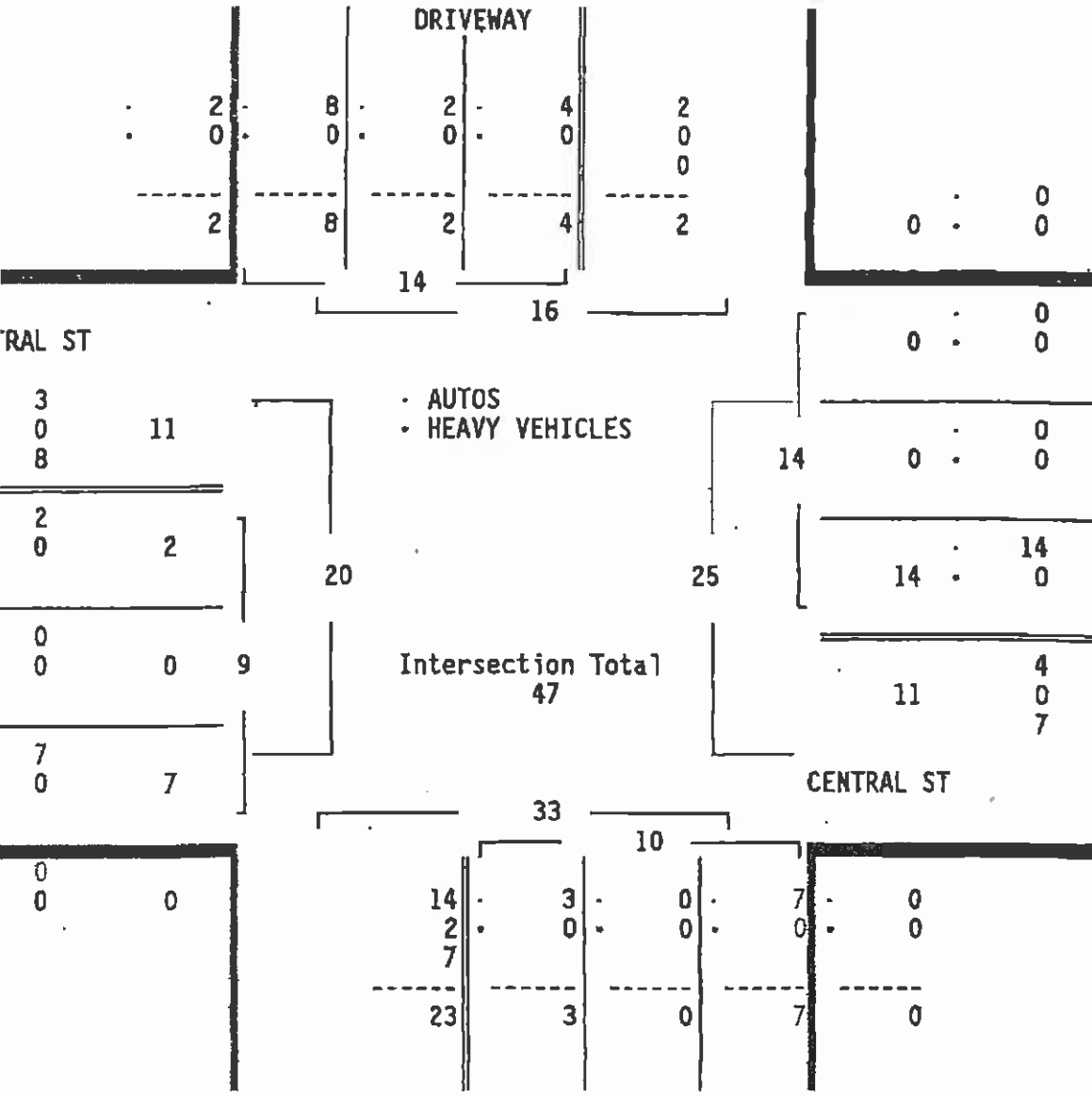

AUTOMATED COUNTS & TRAFFIC SURVEYS INC.  
 2 BURCHARD AVENUE  
 LITTLE COMPTON, RI 02837  
 (401)635-1650

Site Code : 03111903  
 Start Date: 11/19/03  
 File I.D. : GPIS117  
 Page : 1

AUTOS

DRIVEWAY Southbound				CENTRAL ST Westbound				PRATT CT EXT Northbound				CENTRAL ST Eastbound				Total	
Left	Thru	Right	PEDS	Left	Thru	Right	PEDS	Left	Thru	Right	PEDS	Left	Thru	Right	PEDS		
11/19/03																	
1	0	0	0	2	0	0	0	1	0	3	0	3	0	0	0	10	
0	0	0	0	2	0	0	0	2	0	2	1	0	0	0	0	7	
0	0	1	0	0	0	0	0	1	0	4	0	1	0	0	0	7	
0	0	0	0	0	0	0	0	5	0	4	0	2	0	0	0	11	
tal	1	0	1	0	4	0	0	0	9	0	13	1	6	0	0	0	35
0	0	0	0	2	0	2	0	7	0	3	0	0	0	0	0	14	
0	0	0	0	1	0	0	0	2	0	7	0	1	0	0	0	11	
2	0	0	1	1	0	0	0	5	1	3	0	4	0	0	0	17	
3	0	0	0	0	0	0	0	3	0	5	0	0	0	0	0	11	
tal	5	0	0	1	4	0	2	0	17	1	18	0	5	0	0	0	53
* BREAK *																	
0	0	0	0	1	0	1	0	0	0	1	0	0	0	2	0	5	
1	1	1	2	2	0	0	0	1	0	2	0	2	0	1	0	13	
1	0	2	0	3	0	0	0	0	0	2	0	0	0	1	0	9	
1	1	2	0	5	0	0	0	2	0	1	0	0	0	2	0	14	
tal	3	2	5	2	11	0	1	0	3	0	6	0	2	0	6	0	41
1	0	3	0	4	0	0	0	0	0	2	0	0	0	3	0	13	
0	1	0	0	3	0	0	0	0	0	0	0	0	0	0	0	4	
0	0	0	0	6	0	0	0	0	0	8	0	0	0	0	0	14	
0	0	0	0	2	0	0	0	0	0	3	0	0	0	2	0	7	
tal	1	1	3	0	15	0	0	0	0	0	13	0	0	0	5	0	38
L*	10	3	9	3	34	0	3	0	29	1	50	1	13	0	11	0	167





AUTOMATED COUNTS & TRAFFIC SURVEYS INC.  
 2 BURCHARD AVENUE  
 LITTLE COMPTON, RI 02837  
 (401)635-1650

Site Code : 03111903  
 Start Date: 11/19/03  
 File I.D. : GPIS117  
 Page : 1

HEAVY VEHICLES

DRIVEWAY Southbound				CENTRAL ST Westbound				PRATT CT EXT Northbound				CENTRAL ST Eastbound				Total
Left	Thru	Right	Other	Left	Thru	Right	Other	Left	Thru	Right	Other	Left	Thru	Right	Other	
11/19/03																
0	0	0	0	0	0	0	0	0	0	0	0	0	0	0	0	0
0	0	0	0	0	0	0	0	0	0	0	0	0	0	0	0	0
0	0	0	0	0	0	0	0	0	0	1	0	0	0	0	0	1
0	0	0	0	0	0	0	0	0	0	2	0	0	0	0	0	2
0	0	0	0	0	0	0	0	0	0	3	0	0	0	0	0	3
* BREAK *																
0	0	0	0	1	0	0	0	0	0	0	0	0	0	0	0	1
0	0	0	0	0	0	0	0	0	0	0	0	1	0	0	0	1
0	0	0	0	0	0	0	0	0	0	0	0	0	0	0	0	0
1	0	0	0	0	0	0	0	0	0	0	0	0	0	0	0	1
1	0	0	0	1	0	0	0	0	0	0	0	1	0	0	0	3
* BREAK *																
0	0	0	0	1	0	0	0	0	0	0	0	0	0	0	0	1
0	0	0	0	0	0	0	0	0	0	0	0	0	0	0	0	0
0	0	0	0	0	0	0	0	0	0	0	0	0	0	0	0	0
0	0	0	0	0	0	0	0	0	0	0	0	0	0	0	0	0
0	0	0	0	1	0	0	0	0	0	0	0	0	0	0	0	1
* BREAK *																
1	0	0	0	2	0	0	0	0	0	3	0	1	0	0	0	7



AUTOMATED COUNTS & TRAFFIC SURVEYS INC.  
 2 BURCHARD AVENUE  
 LITTLE COMPTON, RI 02837  
 (401)635-1650

Site Code : 03100102  
 Start Date: 10/01/03  
 File I.D. : GPIS1002  
 Page : 1

AUTOS

ISLAND ST Southbound			ISLAND ST Northbound			HILL ST Eastbound			Total	
Thru	Right	PEDS	Left	Thru	PEDS	Left	Right	PEDS		
10/01/03										
23	8	0	1	35	0	12	1	0	80	
30	11	0	1	32	0	8	2	0	84	
22	10	0	3	42	0	13	3	0	93	
17	16	0	2	49	0	17	1	0	102	
<b>tal</b>	<b>92</b>	<b>45</b>	<b>0</b>	<b>7</b>	<b>158</b>	<b>0</b>	<b>50</b>	<b>7</b>	<b>0</b>	<b>359</b>
34	17	0	2	51	0	22	2	0	128	
32	4	2	1	32	0	20	1	0	92	
23	16	0	0	32	0	5	1	0	77	
18	10	0	0	19	0	7	1	0	55	
<b>tal</b>	<b>107</b>	<b>47</b>	<b>2</b>	<b>3</b>	<b>134</b>	<b>0</b>	<b>54</b>	<b>5</b>	<b>0</b>	<b>352</b>
----- * BREAK * -----										
38	19	0	1	31	0	7	0	0	96	
28	17	2	3	23	3	13	1	0	90	
32	15	0	0	21	0	14	2	0	84	
25	15	0	2	26	0	11	0	0	79	
<b>tal</b>	<b>123</b>	<b>66</b>	<b>2</b>	<b>6</b>	<b>101</b>	<b>3</b>	<b>45</b>	<b>3</b>	<b>0</b>	<b>349</b>
30	20	0	1	41	0	16	0	2	110	
45	23	0	0	40	0	10	1	0	119	
26	22	2	1	29	0	15	2	1	98	
34	19	1	0	37	0	12	4	1	108	
<b>tal</b>	<b>135</b>	<b>84</b>	<b>3</b>	<b>2</b>	<b>147</b>	<b>0</b>	<b>53</b>	<b>7</b>	<b>4</b>	<b>435</b>
<b>tal</b>	<b>457</b>	<b>242</b>	<b>7</b>	<b>18</b>	<b>540</b>	<b>3</b>	<b>202</b>	<b>22</b>	<b>4</b>	<b>1495</b>



AUTOMATED COUNTS & TRAFFIC SURVEYS INC.  
 2 BURCHARD AVENUE  
 LITTLE COMPTON, RI 02837  
 (401)635-1650

Site Code : 03100102  
 Start Date: 10/01/03  
 File I.D. : GPIS1002  
 Page : 1

HEAVY VEHICLES

ISLAND ST Southbound			ISLAND ST Northbound			HILL ST Eastbound			Total
Thru	Right	Other	Left	Thru	Other	Left	Right	Other	
0/01/03									
2	0	0	0	4	0	0	0	0	6
3	0	0	0	1	0	0	0	0	4
0	1	0	0	2	0	1	0	0	4
1	0	0	0	2	0	0	0	0	3
al	6	1	0	0	9	1	0	0	17
1	1	0	0	0	0	3	0	0	5
1	0	0	0	3	0	0	0	0	4
2	0	0	0	0	0	1	0	0	3
1	1	0	0	2	0	1	0	0	5
al	5	2	0	0	5	5	0	0	17
* BREAK *									
2	0	0	0	0	0	0	0	0	2
1	0	0	0	1	0	0	1	0	3
1	0	0	0	0	0	0	0	0	1
1	0	0	0	1	0	0	1	0	3
al	5	0	0	0	2	0	2	0	9
1	3	0	0	1	0	0	0	0	5
5	0	0	0	1	0	0	0	0	6
0	0	0	0	0	0	0	0	0	0
0	0	0	0	0	0	0	0	0	0
al	6	3	0	0	2	0	0	0	11
* 22 6 0   0 18 0   6 2 0   54									



AUTOMATED COUNTS & TRAFFIC SURVEYS INC.  
 2 BORCHARD AVENUE  
 LITTLE COMPTON, RI 02837  
 (401)635-1650

Site Code : 03100102  
 Start Date: 10/01/03  
 File I.D. : GPIS1002  
 Page : 1

AUTOS, HEAVY VEHICLES

ISLAND ST Southbound			ISLAND ST Northbound			MILL ST Eastbound			Total	
Thru	Right	PEDS	Left	Thru	PEDS	Left	Right	PEDS		
10/01/03										
25	8	0	1	39	0	12	1	0	86	
33	11	0	1	33	0	8	2	0	88	
22	11	0	3	44	0	14	3	0	97	
18	16	0	2	51	0	17	1	0	105	
al	98	46	0	7	167	0	51	7	0	376
35	18	0	2	51	0	25	2	0	133	
33	4	2	1	35	0	20	1	0	96	
25	16	0	0	32	0	6	1	0	80	
19	11	0	0	21	0	8	1	0	60	
al	112	49	2	3	139	0	59	5	0	369
* BREAK *										
40	19	0	1	31	0	7	0	0	98	
29	17	2	3	24	3	13	2	0	93	
33	15	0	0	21	0	14	2	0	85	
26	15	0	2	27	0	11	1	0	82	
al	128	66	2	6	103	3	45	5	0	358
31	23	0	1	42	0	16	0	2	115	
50	23	0	0	41	0	10	1	0	125	
26	22	2	1	29	0	15	2	1	98	
34	19	1	0	37	0	12	4	1	108	
al	141	87	3	2	149	0	53	7	4	446
* al	479	248	7	18	558	3	208	24	4	1549

AUTOMATED COUNTS & TRAFFIC SURVEYS INC.  
 2 BURCHARD AVENUE  
 LITTLE COMPTON, RI 02837  
 (401)635-1650

Site Code : 03100102  
 Start Date: 10/01/03  
 File I.D. : GPIS1002  
 Page : 2

AUTOS, HEAVY VEHICLES

ISLAND ST Southbound	ISLAND ST Northbound	MILL ST Eastbound		Total
Thru Right Peds	Left Thru Peds	Left Right Peds		

10/01/03

		ISLAND ST			
7	242	457	208		
0	6	22	558		
7	248	479	0	766	
		727			
		1,493			
ST					
18	266	• AUTOS			
0		• HEAVY VEHICLES			
248					
202					
6	208				
		498			
		Intersection Total			
		1,535			
22					
2	24				
		1,079			
		576			
4		0	18	540	3
0	4	479	0	18	0
		24			
		503	18	558	0
		ISLAND ST			



AUTOMATED COUNTS & TRAFFIC SURVEYS INC.  
 2 BURCHARD AVENUE  
 LITTLE COMPTON, RI 02837  
 (401)635-1650

Site Code : 03100102  
 Start Date: 10/01/03  
 File I.D. : GPIS1002  
 Page : 3

PR : CLEAR/COOL  
 PR : D-2616  
 ed by: JTS  
 its: STOUGHTON

AUTOS, HEAVY VEHICLES

ISLAND ST Southbound			ISLAND ST Northbound			HILL ST Eastbound			Total
Thru	Right	PEDS	Left	Thru	PEDS	Left	Right	PEDS	
10/01/03									
Four Analysis By Individual Approach for the Period: 07:00 to 12:30 on 10/01/03									
Start 07:45									
	111	54	2	8	181	0	76	7	0
it	66	32	1	4	96	0	92	8	0
al	167			189			83		
Start 08:00									
	35	18	0	2	51	0	25	2	0
al	53			53			27		
	.79			.89			.77		

AUTOMATED COUNTS & TRAFFIC SURVEYS INC.  
 2 BURCHARD AVENUE  
 LITTLE COMPTON, RI 02837  
 (401)635-1650

Site Code : 03100102  
 Start Date: 10/01/03  
 File I.D. : GPIS1002  
 Page : 4

AUTOS, HEAVY VEHICLES

ISLAND ST Southbound			ISLAND ST Northbound			HILL ST Eastbound			Total
Thru	Right	PEDS	Left	Thru	PEDS	Left	Right	PEDS	

10/01/03  
 Hour Analysis By Entire Intersection for the Period: 07:00 to 12:30 on 10/01/03

start	end	ISLAND ST Southbound	ISLAND ST Northbound	HILL ST Eastbound
07:30	07:30	8	181	76
	07:30	4	96	8
	07:30	1	0	0
	07:30	189		83
08:00	07:45	2	51	25
	08:00	53		27
	08:00	.75	.89	.77

ISLAND ST				
2	47	105		76
0	2	3		181
				0
2	49	108	0	257
157		414		

ISLAND ST				
8	57	140		AUTOS
0				HEAVY VEHICLES
49				
72	76	Intersection Total 429		
4				
	0	83		
7	7			
0				
0	0	304	189	
		0	8	174
		108	0	7
		7		
115	8	181	0	0

AUTOMATED COUNTS & TRAFFIC SURVEYS INC.  
 2 BURCHARD AVENUE  
 LITTLE COMPTON, RI 02837  
 (401)635-1650

Site Code : 03100102  
 Start Date: 10/01/03  
 File I.D. : GPIS1002  
 Page : 5

AUTOS, HEAVY VEHICLES

ISLAND ST Southbound				ISLAND ST Northbound			HILL ST Eastbound			Total
Thru	Right	PEDS		Left	Thru	PEDS	Left	Right	PEDS	
10/01/03										
Hour Analysis By Individual Approach for the Period: 12:30 to 18:00 on 10/01/03										
start 17:00				17:00			17:00			
ie	141	87	3	2	149	0	53	7	4	
nt	61	38	1	1	99	0	83	11	6	
tal	231			151			64			
st 17:15				17:00			17:00			
e	50	23	0	1	42	0	16	0	2	
tal	73			43			18			
	.79			.88			.89			

AUTOMATED COUNTS & TRAFFIC SURVEYS INC.  
 2 BURCHARD AVENUE  
 LITTLE COMPTON, RI 02837  
 (401)635-1650

Site Code : 03100102  
 Start Date: 10/01/03  
 File I.D. : GPIS1002  
 Page : 6

AUTOS, HEAVY VEHICLES

ISLAND ST Southbound				ISLAND ST Northbound				HILL ST Eastbound				Total
Thru	Right	PEDS		Left	Thru	PEDS		Left	Right	PEDS		
10/01/03												
Hour Analysis By Entire Intersection for the Period: 12:30 to 18:00 on 10/01/03												
start 17:00				17:00				17:00				
g	141	87	3	2	149	0		53	7	4		
nt	61	38	1	1	99	0		83	11	6		
tal	231			151				64				
st 17:15				17:00				17:00				
g	50	23	0	1	42	0		16	0	2		
tal	73			43				18				
	.79			.88				.89				

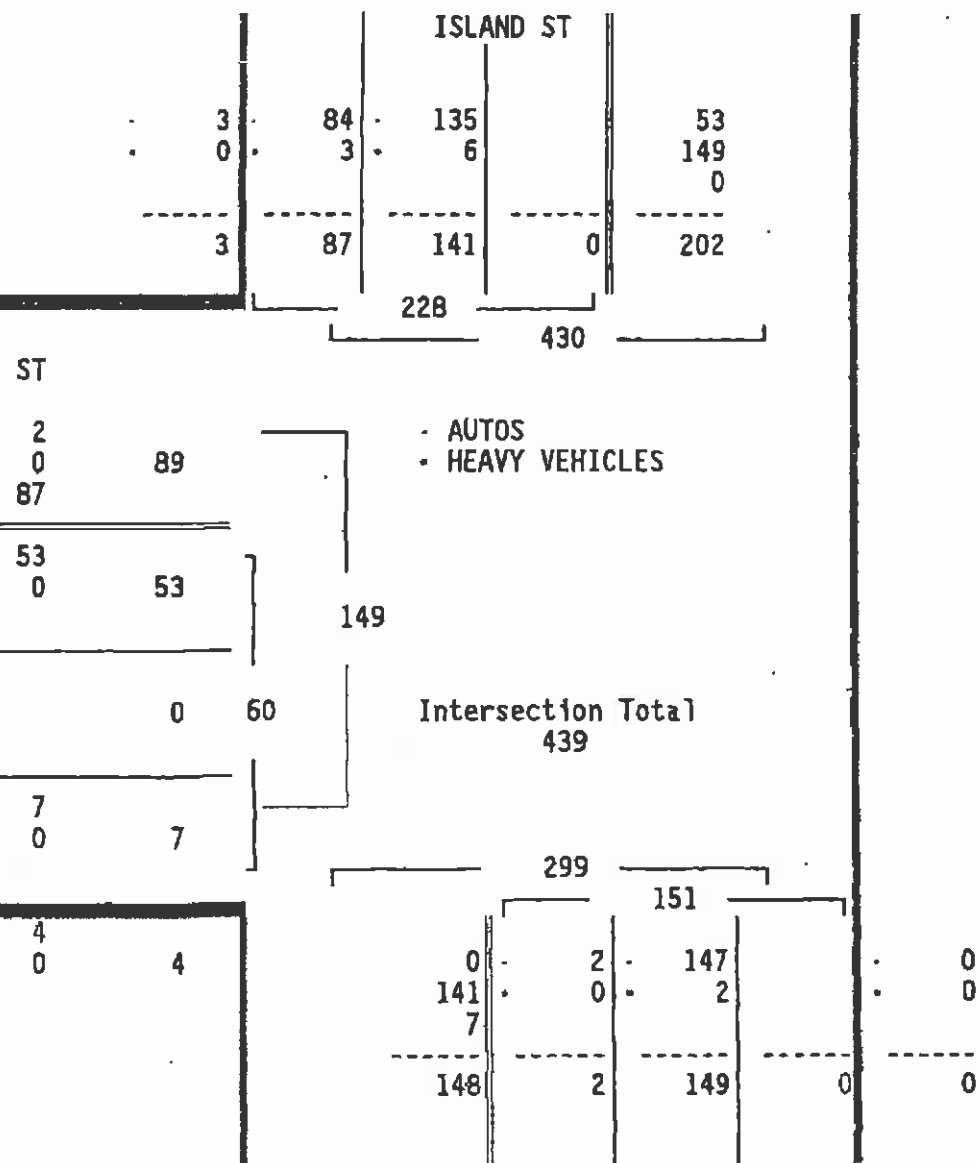

**TRAFFIC IMPACT AND ACCESS STUDY**

---

Woodbridge Crossing Residential Development, Stoughton, Massachusetts

**MASSHIGHWAY SEASONAL ADJUSTMENT AND GROWTH DATA**

---

MASSACHUSETTS HIGHWAY DEPARTMENT - STATEWIDE TRAFFIC DATA COLLECTION

2003 WEEKDAY SEASONAL FACTORS \*

\* Note: These are weekday factors. The average of the factors for the year will not equal 1, as weekend data are not considered.

FACTOR GROUP	JAN	FEB	MAR	APR	MAY	JUN	JUL	AUG	SEP	OCT	NOV	DEC
GROUP 1 - WEST INTERSTATE	1.00	1.01	0.89	0.86	0.87	0.85	0.92	0.90	0.89	0.90	0.92	0.93
GROUP 2 - RURAL MAJOR COLLECTOR (R-5)	1.16	1.12	1.08	1.02	0.93	0.88	0.87	0.88	0.93	0.93	1.02	1.05
GROUP 3A - RECREATIONAL ** (1-4) See below	1.30	1.24	1.16	1.06	0.98	0.86	0.79	0.78	0.93	0.97	1.06	1.14
GROUP 3B - RECREATIONAL *** (5) See below	1.35	1.28	1.23	1.13	1.01	0.86	0.77	0.76	0.99	1.03	1.10	1.17
GROUP 4 - I-495 INTERSTATE	1.06	1.04	1.00	0.95	0.92	0.86	0.86	0.83	0.90	0.92	0.86	1.00
GROUP 5 - EAST INTERSTATE	1.07	1.03	0.97	0.95	0.94	0.89	0.92	0.80	0.92	0.93	0.94	0.97
GROUP 6 - URBAN ARTERIALS, COLLECTORS & RURAL ARTERIALS (R-2, R-3)	1.06	1.02	0.98	0.95	0.92	0.90	0.92	0.90	0.91	0.92	0.95	0.97
GROUP 7 - I-84 PROXIMITY (STA. 17)	1.31	1.28	1.16	1.10	0.97	0.87	0.90	0.89	0.89	1.08	1.11	1.26
GROUP 8 - I-295 PROXIMITY (STA. 6590)	1.07	1.05	0.98	0.93	0.92	0.88	0.91	0.87	0.88	0.89	0.89	0.88
GROUP 9 - I-195 PROXIMITY (STA. 7)	1.19	1.12	1.07	0.99	0.93	0.85	0.82	0.80	0.91	0.94	1.00	1.05

RECREATIONAL: (ALL YEARS)

- \*\*GROUP 3A:  
1. CAPE COD (ALL TOWNS)  
2. PLYMOUTH (SOUTH OF RTE. 3A)  
7075, 7080, 7085, 7091, 7092, 7093, 7084, 7086, 7087, 7100, 7178
- 3. MARTHA'S VINEYARD  
4. NANTUCKET
- \*\*\*GROUP 3B:  
5. PERMANENTS 2 & 189  
1066, 1067, 1068, 1069, 1085, 1086, 1087, 1088, 1089, 1090, 1091, 1092,  
1093, 1094, 1095, 1096, 1097, 1098, 1099, 1100, 1101, 1102, 1103, 1104,  
1105, 1106, 1107, 1108, 1113, 1114, 1118, 2188, 2197, 2199

2003 AXLE CORRECTION FACTORS

ROAD INVENTORY FUNCTIONAL CLASSIFICATION	AXLE CORRECTION FACTOR
R-1	0.93
R-2	0.97
R-3	0.98
R-5	0.98
U-1	0.96
U-2, U-3, U-4	0.97
U-5	0.99
U-6	0.99
I-84	0.73

Apply I-84 factor to stations: 3290, 3821, 3928

ROUND OFF

- 0 - 998 ..... 10
- > 1,000 ..... 100

TRAFFIC GROWTH SUMMARY

DISTRICT 5

STATION	URBAN/RURAL	2002	2003	% CHANGE
3	U2	9,414	9,801	4.1
7	R1	37,158	37,294	0.4
10	U1	72,645	73,869	1.7
15	R2	53,845	53,402	-0.8
20	R2	38,508	38,288	-0.6
25	U6	9,415	9,809	4.2
28	U5	11,992	11,694	-2.5
601	U1	60,579	60,414	-0.3
617	U2	31,788	32,052	0.8
650	U1	112,619	112,948	0.3
703	U3	13,575	13,930	2.6
707	R2	43,981	44,841	1.5
708	R2	54,905	54,417	-0.9
709	U3	21,597	20,970	-2.9
725	U1	58,398	57,731	-1.1
6084	U1	91,729	91,291	-0.5
6089	U1	95,983	95,105	-0.9
6090	U1	89,535	91,205	1.9
6527	U1	82,363	81,769	-0.7
6590	U1	45,284	47,516	4.9
6647	U5	14,711	14,671	-0.3
	TOTAL URBAN	1,061,595	1,055,622	0.4
	TOTAL RURAL	228,397	228,042	-0.2
	TOTAL URBAN AND RURAL	1,289,992	1,293,664	0.3

**TRAFFIC IMPACT AND ACCESS STUDY**

---

Woodbridge Crossing Residential Development, Stoughton, Massachusetts

**ACCIDENT CRASH RATE WORKSHEETS**

---



# MassHighway

## CRASH RATE WORKSHEET

CITY/TOWN : Stoughton COUNT DATE : 10/1/2003

DISTRICT : 5 UNSIGNALIZED :  X SIGNALIZED :

**MHD USE ONLY**

Source #

~ INTERSECTION DATA ~

MAJOR STREET : Central Street (Route 27)

MINOR STREET(S) : West Street

RIN #

RIN #

RIN #

RIN #

RIN #

INTERSECTION  
DIAGRAM  
(Label Approaches)

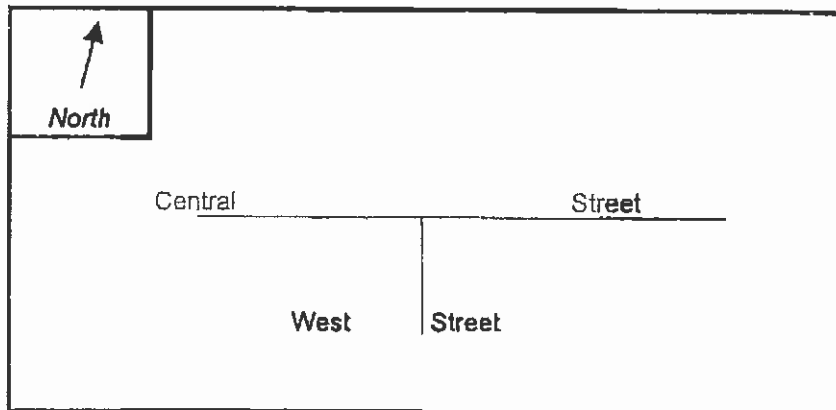

INTERSECTION

REF #

Peak Hour Volumes

APPROACH :	1	2	3	4	5	6
DIRECTION :	NB	SB	EB	WB		
VOLUMES (AM/PM) :	231	0	1007	1135		

"K" FACTOR :  APPROACH ADT :  ADT = TOTAL VOL/"K" FACT.

TOTAL # OF ACCIDENTS :  # OF YEARS :  AVERAGE # OF ACCIDENTS ( A ) :

CRASH RATE CALCULATION :  RATE =  $\frac{(A * 1,000,000)}{(ADT * 365)}$

Comments : Of the five accidents, 4 were identified as property damage only, and 1 was identified as injury. There were no fatalities.

# MassHighway

## CRASH RATE WORKSHEET

CITY/TOWN : Stoughton COUNT DATE : 10/1/2003

DISTRICT : 5 UNSIGNALIZED :  X SIGNALIZED :

**MHD USE ONLY**

Source #

- INTERSECTION DATA -

MAJOR STREET : Central Street (Route 27)

RIN #

MINOR STREET(S) : Island Street

RIN #

RIN #

RIN #

RIN #

INTERSECTION  
DIAGRAM  
(Label Approaches)

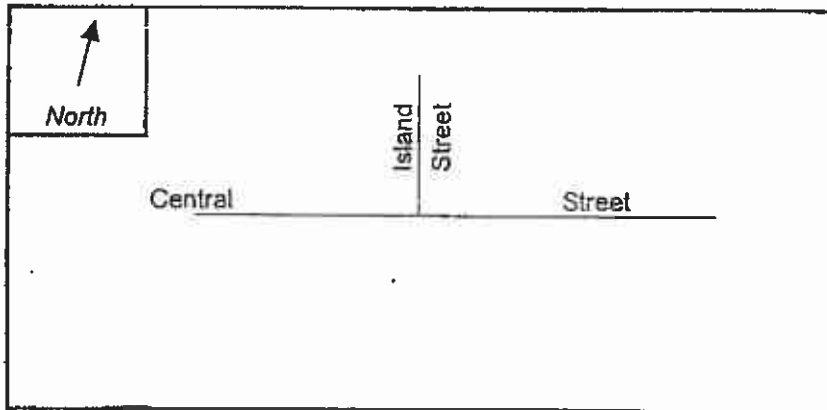

INTERSECTION

REF #

Peak Hour Volumes

APPROACH :	1	2	3	4	5	6
DIRECTION :	NB	SB	EB	WB		
VOLUMES (AM/PM) :	0	194	1104	1160		

"K" FACTOR :  APPROACH ADT :  ADT = TOTAL VOL/"K" FACT.

TOTAL # OF ACCIDENTS :  # OF YEARS :  AVERAGE # OF ACCIDENTS ( A ) :

CRASH RATE CALCULATION :  RATE =  $\frac{(A * 1,000,000)}{(ADT * 365)}$

Comments : Of the 29 accidents, 19 were identified as property damage only, and 10 were identified as injury. There were no fatalities.

# MassHighway

## CRASH RATE WORKSHEET

CITY/TOWN : Stoughton COUNT DATE : 10/1/2003

DISTRICT : 5 UNSIGNALIZED :  X SIGNALIZED :

**MKD USE ONLY**

Source #

- INTERSECTION DATA -

MAJOR STREET : Central Street (Route 27)

MINOR STREET(S) : Mill Street

RIN #

RIN #

RIN #

RIN #

RIN #

INTERSECTION  
DIAGRAM  
(Label Approaches)

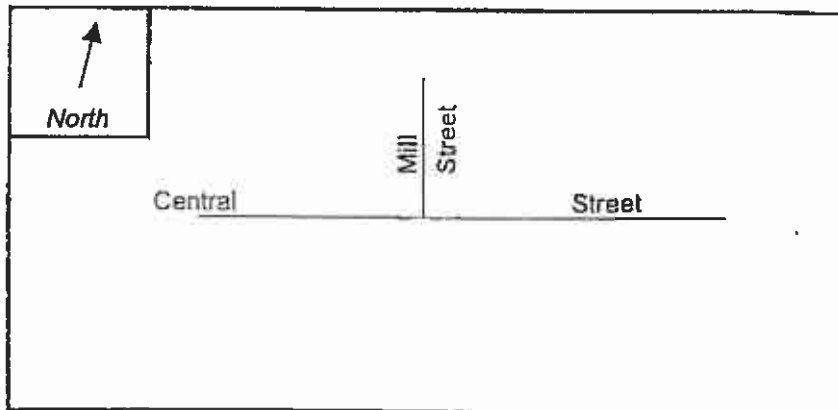

INTERSECTION

REF #

Peak Hour Volumes

APPROACH :	1	2	3	4	5	6
DIRECTION :	NB	SB	EB	WB		
VOLUMES (AM/PM) :	0	84	1049	945		

"K" FACTOR :  APPROACH ADT :  ADT = TOTAL VOL\*"K" FACT.

TOTAL # OF ACCIDENTS :  # OF YEARS :  AVERAGE # OF ACCIDENTS ( A ) :

CRASH RATE CALCULATION :  RATE =  $\frac{(A * 1,000,000)}{(ADT * 365)}$

Comments : Of the four accidents, all 4 were identified as property damage only, There were no injuries or fatalities.

# MassHighway

## CRASH RATE WORKSHEET

CITY/TOWN : Stoughton      COUNT DATE : 11/1/2003  
 DISTRICT : 5      UNSIGNALIZED :  X      SIGNALIZED :

**MHD USE ONLY**

Source #

~ INTERSECTION DATA ~

MAJOR STREET : Canton Street (Route 27)  
 MINOR STREET(S) : Central Street

RIN #   
 RIN #   
 RIN #   
 RIN #   
 RIN #

INTERSECTION  
 DIAGRAM  
 (Label Approaches)

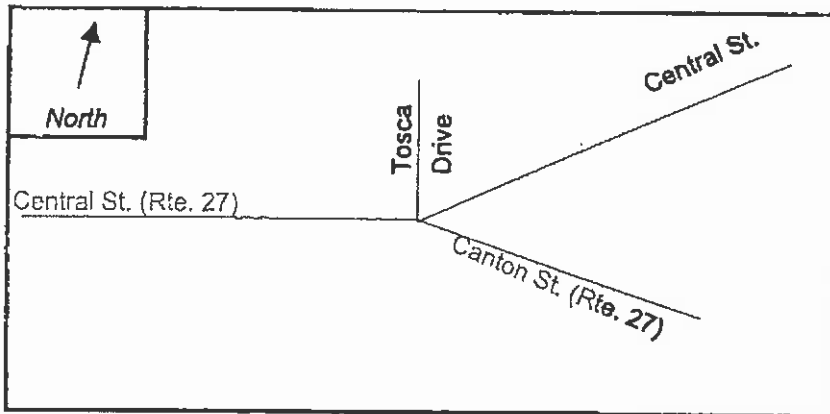

INTERSECTION  
 REF #

**Peak Hour Volumes**

APPROACH :	1	2	3	4	5	6
DIRECTION :	NB	SB	EB	WB		
VOLUMES (AM/PM) :	394	146	1169	704		

"K" FACTOR :       APPROACH ADT :       ADT = TOTAL VOL \* "K" FACT.

TOTAL # OF ACCIDENTS :       # OF YEARS :       AVERAGE # OF ACCIDENTS ( A ) :

CRASH RATE CALCULATION :       RATE =  $\frac{(A * 1,000,000)}{(ADT * 365)}$

Comments : Of the eleven accidents, 5 were identified as property damage only, and 6 were identified as injury. There were no fatalities.

# MassHighway

## CRASH RATE WORKSHEET

CITY/TOWN : Stoughton COUNT DATE : 11/1/2003

DISTRICT : 5 UNSIGNALIZED :  X SIGNALIZED :

**MHD USE ONLY**

Source #

~ INTERSECTION DATA ~

MAJOR STREET : Central Street

MINOR STREET(S) : Pratts Court

RIN #

RIN #

RIN #

RIN #

RIN #

INTERSECTION  
DIAGRAM  
(Label Approaches)

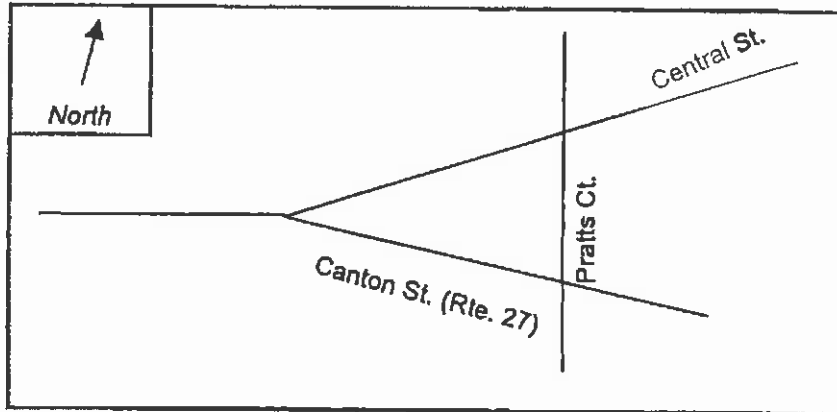

INTERSECTION

REF #

Peak Hour Volumes

APPROACH :	1	2	3	4	5	6
DIRECTION :	NB	SB	EB	WB		
VOLUMES (AM/PM) :	13	18	591	786		

"K" FACTOR :  APPROACH ADT :  ADT = TOTAL VOL/"K" FACT.

TOTAL # OF ACCIDENTS :  # OF YEARS :  AVERAGE # OF ACCIDENTS ( A ) :

CRASH RATE CALCULATION :  RATE =  $\frac{(A * 1,000,000)}{(ADT * 365)}$

Comments : The one accident that occurred was identified as property damage only.  
There were no fatalities.



**TRAFFIC IMPACT AND ACCESS STUDY**

---

Woodbridge Crossing Residential Development, Stoughton, Massachusetts

**TRIP-GENERATION CALCULATIONS**

---

***Institute of Transportation Engineers (ITE)***  
**Land Use Code (LUC) 223 - Mid-Rise Apartment**

Average Vehicle Trips Ends vs: Dwelling Units  
Independent Variable (X): 208

**AVERAGE WEEKDAY DAILY** (*ITE LUC 220 - Apartment*)

$$\frac{\text{ITE LUC 220 Weekday Daily Trip Rate}}{\text{ITE LUC 220 Weekday Morning Trip Rate}} = \frac{\text{ITE LUC 223 Weekday Daily Trip Rate}}{\text{ITE LUC 223 Weekday Morning Trip Rate}}$$

$$\frac{6.72}{0.51} = \frac{(Y)}{0.30} \quad Y = 3.95$$

$$T = Y * 208$$

$$T = 822.21$$

T = 822 vehicle trips

with 50% ( 411 vph) entering and 50% ( 411 vph) exiting.

**WEEKDAY MORNING PEAK HOUR OF ADJACENT STREET TRAFFIC**

$$T = 0.41 * (X) - 13.06$$

$$T = 0.41 * 208 - (13.06)$$

$$T = 72.22$$

T = 72 vehicle trips

with 31% ( 22 vph) entering and 69% ( 50 vph) exiting.

**WEEKDAY EVENING PEAK HOUR OF ADJACENT STREET TRAFFIC**

$$T = 0.48 * (X) - 11.07$$

$$T = 0.48 * 208 - (11.07)$$

$$T = 88.77$$

T = 89 vehicle trips

with 58% ( 52 vph) entering and 42% ( 37 vph) exiting.



*Institute of Transportation Engineers (ITE)*

**Land Use Code (LUC) 230 - Residential Condominium/Townhouse**

Average Vehicle Trips Ends vs: Dwelling Units  
Independent Variable (X): 194

**AVERAGE WEEKDAY DAILY**

$$\ln T = 0.850 \ln (X) + 2.55$$

$$\ln T = 0.850 \ln 194 + (2.55)$$

$$\ln T = 7.03$$

$$T = 1127.41$$

$$T = 1,128 \text{ vehicle trips}$$

with 50% ( 564 vpd) entering and 50% ( 564 vpd) exiting.

**WEEKDAY MORNING PEAK HOUR OF ADJACENT STREET TRAFFIC**

$$\ln T = 0.80 \ln (X) + 0.26$$

$$\ln T = 0.80 \ln 194 + (0.26)$$

$$\ln T = 4.47$$

$$T = 87.73$$

$$T = 88 \text{ vehicle trips}$$

with 17% ( 15 vpd) entering and 83% ( 73 vpd) exiting.

**WEEKDAY EVENING PEAK HOUR OF ADJACENT STREET TRAFFIC**

$$\ln T = 0.82 \ln (X) + 0.32$$

$$\ln T = 0.82 \ln 194 + (0.32)$$

$$\ln T = 4.64$$

$$T = 103.51$$

$$T = 104 \text{ vehicle trips}$$

with 67% ( 70 vph) entering and 33% ( 34 vph) exiting.

**SATURDAY DAILY**

$$T = 3.62 * (X) + 427.93$$

$$T = 3.62 * 194 + (427.93)$$

$$T = 1130.21$$

$$T = 1,130 \text{ vehicle trips}$$

with 50% ( 565 vpd) entering and 50% ( 565 vpd) exiting.

**SATURDAY MIDDAY PEAK HOUR OF GENERATOR**

$$T = 0.29 * (X) + 42.63$$

$$T = 0.29 * 194 + (42.63)$$

$$T = 98.89$$

$$T = 98 \text{ vehicle trips}$$

with 54% ( 53 vph) entering and 46% ( 45 vph) exiting.

*Institute of Transportation Engineers (ITE)*  
**Land Use Code (LUC) 110 - General Light Industrial**

Average Vehicle Trips Ends vs: 1000 Sq. Feet Gross Floor Area  
Independent Variable (X): 84.400

**AVERAGE WEEKDAY DAILY**

$$T = 6.970 * (X)$$

$$T = 6.970 * 84.400$$

$$T = 588.27$$

$$T = 588 \text{ vehicle trips}$$

with 50% ( 294 vpd) entering and 50% ( 294 vpd) exiting.

**WEEKDAY MORNING PEAK HOUR OF ADJACENT STREET TRAFFIC**

$$T = 0.920 * (X)$$

$$T = 0.920 * 84.400$$

$$T = 77.65$$

$$T = 78 \text{ vehicle trips}$$

with 88% ( 69 vph) entering and 12% ( 9 vph) exiting.

**WEEKDAY EVENING PEAK HOUR OF ADJACENT STREET TRAFFIC**

$$T = 0.980 * (X)$$

$$T = 0.980 * 84.400$$

$$T = 82.71$$

$$T = 83 \text{ vehicle trips}$$

with 12% ( 10 vph) entering and 88% ( 73 vph) exiting.

*Institute of Transportation Engineers (ITE)*  
Land Use Code (LUC) 220 - Apartment

Average Vehicle Trips Ends vs: Dwelling Units  
Independent Variable (X): 132

**AVERAGE WEEKDAY DAILY**

$$T = 6.01 * (X) + 150.35$$

$$T = 6.01 * 132 + (150.35)$$

$$T = 943.67$$

$$T = 944 \text{ vehicle trips}$$

with 50% ( 472 vpd) entering and 50% ( 472 vpd) exiting.

**WEEKDAY MORNING PEAK HOUR OF ADJACENT STREET TRAFFIC**

$$T = 0.49 * (X) + 3.73$$

$$T = 0.49 * 132 + (3.73)$$

$$T = 68.41$$

$$T = 68 \text{ vehicle trips}$$

with 20% ( 14 vph) entering and 80% ( 54 vph) exiting.

**WEEKDAY EVENING PEAK HOUR OF ADJACENT STREET TRAFFIC**

$$T = 0.55 * (X) + 17.65$$

$$T = 0.55 * 132 + (17.65)$$

$$T = 90.25$$

$$T = 90 \text{ vehicle trips}$$

with 65% ( 59 vph) entering and 35% ( 31 vph) exiting.

**SATURDAY DAILY**

$$T = 6.39 * (X)$$

$$T = 6.39 * 132$$

$$T = 843.48$$

$$T = 844 \text{ vehicle trips}$$

with 50% ( 422 vpd) entering and 50% ( 422 vpd) exiting.

**SATURDAY MIDDAY PEAK HOUR OF GENERATOR**

$$T = 0.41 * (X) + 19.23$$

$$T = 0.41 * 132 + (19.23)$$

$$T = 73.35$$

$$T = 73 \text{ vehicle trips}$$

with 50% ( 37 vph) entering and 50% ( 36 vph) exiting.

**TRAFFIC IMPACT AND ACCESS STUDY**

---

Woodbridge Crossing Residential Development, Stoughton, Massachusetts

**CAPACITY ANALYSIS METHODOLOGY**

---

## **CAPACITY ANALYSIS METHODOLOGY**

A primary result of capacity analysis is the assignment of levels of service to traffic facilities under various traffic flow conditions. The capacity analysis methodology is based on the concepts and procedures in the *Highway Capacity Manual (HCM)*.<sup>6</sup> The concept of level of service (LOS) is defined as a qualitative measure describing operational conditions within a traffic stream and their perception by motorists and/or passengers. A level-of-service definition provides an index to quality of traffic flow in terms of such factors as speed, travel time, freedom to maneuver, traffic interruptions, comfort, convenience, and safety.

Six levels of service are defined for each type of facility. They are given letter designations from A to F, with LOS A representing the best operating conditions and LOS F the worst. Since the level of service of a traffic facility is a function of the traffic flows placed upon it, such a facility may operate at a wide range of levels of service, depending on the time of day, day of week, or period of year. A description of the operating condition under each level of service is provided below:

- *LOS A* describes conditions with little to no delay to motorists.
- *LOS B* represents a desirable level with relatively low delay to motorists.
- *LOS C* describes conditions with average delays to motorists.
- *LOS D* describes operations where the influence of congestion becomes more noticeable. Delays are still within an acceptable range.
- *LOS E* represents operating conditions with high delay values. This level is considered by many agencies to be the limit of acceptable delay.
- *LOS F* is considered to be unacceptable to most drivers with high delay values that often occur, when arrival flow rates exceed the capacity of the intersection.

### **Unsignalized Intersections**

Levels of service for unsignalized intersections are calculated using the operational analysis methodology of the HCM. The procedure accounts for lane configuration on both the minor and major street approaches, conflicting traffic stream volumes, and the type of intersection control

---

<sup>6</sup>*Highway Capacity Manual 2000*, Transportation Research Board; Washington, D.C.; 2000.

---

## TRAFFIC IMPACT AND ACCESS STUDY

Woodbridge Crossing Residential Development, Stoughton, Massachusetts

(STOP, YIELD, or all-way STOP control). The definition of level of service for unsignalized intersections is a function of average *control* delay. Control delay includes initial deceleration delay, queue move-up time, stopped delay, and final acceleration delay. The level-of-service criteria for unsignalized intersections are shown in Table A1.

### Signalized Intersections

Levels of service for signalized intersections are also calculated using the operational analysis methodology of the HCM. The methodology for signalized intersections assesses the effects of signal type, timing, phasing, and progression; vehicle mix; and geometrics on average *control* delay. Control delay includes initial deceleration delay, queue move-up time, stopped delay, and final acceleration delay. Table A1 summarizes the relationship between level of service and average control delay.

**Table A1**  
**LEVEL-OF-SERVICE CRITERIA FOR INTERSECTIONS**

Level of Service	Unsignalized Intersection Criteria Average Control Delay (Seconds per Vehicle)	Signalized Intersection Criteria Average Control Delay (Seconds per Vehicle)
A	≤10	≤10
B	>10 and ≤15	>10 and ≤20
C	>15 and ≤25	>20 and ≤35
D	>25 and ≤35	>35 and ≤55
E	>35 and ≤50	>55 and ≤80
F	>50	>80

Source: *Highway Capacity Manual 2000*, Transportation Research Board; Washington, D.C.; 2000. Pages 10-16 and 17-2.

For signalized intersections, this delay criterion may be applied in assigning level-of-service designations to individual lane groups, to individual intersection approaches, or to the entire intersection. For unsignalized intersections, this delay criterion may be applied in assigning level-of-service designations to individual lane groups or to individual intersection approaches.